

Lubrication Adapter

An oil-only lubrication adapter is available for models NR/NRS.

Even if the LM Guide is installed in an orientation where oil lubrication is difficult, such as wall mount and inversed mount, the adapter is capable of feeding a constant quantity of lubricant to the four raceways.

Features

The dedicated lubrication adapter for models NR/NRS is built in with a constant quantity distributor. Therefore, the adapter can accurately feed a constant quantity of lubricant to each raceway regardless of the mounting orientation.

The adapter is economical since it constantly feeds the optimum amount of lubricant and can eliminate the supply of surplus lubricant.

To arrange the piping, simply connect an intermittent lubrication pump widely used for ordinary machine tools to the lubrication holes (M8) on the front and the side of the lubrication adapter.

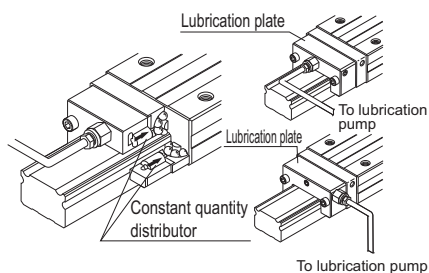

Structural Drawing

Specifications

Viscosity range of lubricant used	32 to 64 mm ² /s recommended
Discharge	0.03×4, 0.06×4 cc/1 shot
Diameter of pipe connected	φ 4, φ 6
Material	Aluminum alloy

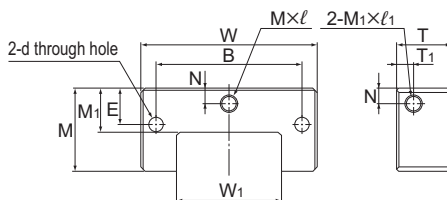

Dimensional Table

Unit: mm

Model No.	Main dimensions												Quantity per shot (cc)
	Width W	Height M	T	W ₁	M ₁	B	E	N	T ₁	d	M×ℓ	M ₁ ×ℓ ₁	
A30N	56	29	25	29	14.5	46	14	5	5.3	3.5	M8×8	M8×8	0.03×4
A35N	66	33	25	35	17	54	16.5	6	5.3	4.5	M8×8	M8×8	
A45N	81	38	25	48	20	67	16.5	7	7.8	6.6	M8×8	M8×8	
A55N	94	45.5	25	56	22	76	20.5	7	7.8	6.6	M8×8	M8×8	0.06×4
A65N	119	55.5	25	67	26.3	92	25.5	11.5	7.8	9	M8×8	M8×8	
A85N	147	68.5	25	92	34	114	32	15.5	7.8	9	M8×8	M8×8	