

Intermediate Flange (Motor Wrap)

[Motors Used and Applicable Intermediate Flanges for Model KR]

Several types of intermediate flanges for mounting motors are available.

In model coding 7, "With/without motor," specify an intermediate flange that matches the motor used: R1, R2, R3, R4, R5, or R6.

Symbol Coding

Wrap symbol ①	Intermediate flange ②	Motor shaft diameter (mm) ③	Motor shaft securing method ④
W	Q	08	D
W	Please refer to "Motors Used and Corresponding Housing A and Intermediate Flanges" below.	Please specify a motor shaft diameter. (Please refer to "Motors Used and Corresponding Housing A and Intermediate Flanges" below.)	K : Key D : Flat M : Friction fastener

Motor shaft securing method

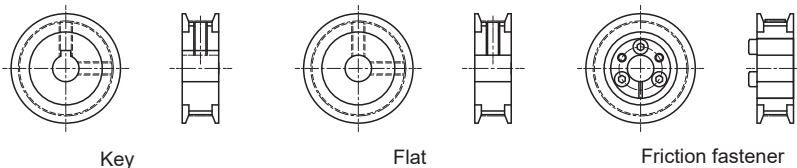

Table16 Motors Used and Corresponding Housing A and Intermediate Flanges

Motor type		Rated output	Flange size	KR											
				KR15	KR20	KR26	KR30H	KR33	KR45H	KR46	KR55	KR65			
AC servo motor Yaskawa Electric	Σ-V mini	SGMMV-A1	10 W	WN-05D	WN-05D	WN-05D	—	—	—	—	—	—	—	—	—
		SGMMV-A2	20 W	□25	WN-05D	WN-05D	WN-05D	—	—	—	—	—	—	—	—
		SGMMV-A3	30 W	□25	WN-05D	WN-05D	WN-05D	—	—	—	—	—	—	—	—
	Σ-V	SGMJV-A5	50 W	□40	—	WQ-08K	WQ-08K	WQ-08K WQ-08M	WQ-08K WQ-08M	—	—	—	—	—	
					—	WQ-08K	WQ-08K	WQ-08K WQ-08M	WQ-08K WQ-08M	—	—	—	—	—	
		SGMAV-A5	100 W		—	—	—	WQ-08K WQ-08M	WQ-08K WQ-08M	—	—	—	—	—	
					—	—	—	WQ-08K WQ-08M	WQ-08K WQ-08M	—	—	—	—	—	
		SGMJV-C2	150 W		□60	—	—	—	WQ-08K WQ-08M	WQ-08K WQ-08M	—	—	—	—	—
						—	—	—	WQ-08K WQ-08M	WQ-08K WQ-08M	—	—	—	—	—
		SGMJV-02	200 W			—	—	—	—	—	WV-14M	WV-14M	WV-14M	WV-14M	WV-14M
						—	—	—	—	—	WV-14M	WV-14M	WV-14M	WV-14M	WV-14M
		SGMAV-02	400 W			—	—	—	—	—	WV-14M	WV-14M	WV-14M	WV-14M	WV-14M
	—			—		—	—	—	WV-14M	WV-14M	WV-14M	WV-14M	WV-14M		
	SGMJV-04	600 W	—	—		—	—	—	WV-14M	WV-14M	WV-14M	WV-14M	WV-14M		
			—	—		—	—	—	WV-14M	WV-14M	WV-14M	WV-14M	WV-14M		
	SGMAV-04	750 W	□80	—		—	—	—	—	—	—	—	WZ-19M	WZ-19M	
—				—	—	—	—	—	—	—	WZ-19M	WZ-19M			

Motor type		Rated output	Flange size	KR											
				KR15	KR20	KR26	KR30H	KR33	KR45H	KR46	KR55	KR65			
AC servo motor	Yaskawa Electric	Σ -7	50 W	\square 40	—	WQ-08K	WQ-08K	WQ-08K WQ-08M	WQ-08K WQ-08M	—	—	—	—		
					—	WQ-08K	WQ-08K	WQ-08K WQ-08M	WQ-08K WQ-08M	—	—	—	—		
			100 W		—	—	—	WQ-08K WQ-08M	WQ-08K WQ-08M	—	—	—	—		
					—	—	—	WQ-08K WQ-08M	WQ-08K WQ-08M	—	—	—	—		
			150 W		—	—	—	WQ-08K WQ-08M	WQ-08K WQ-08M	—	—	—	—		
			200 W		—	—	—	—	—	—	WV-14M	WV-14M	WV-14M	WV-14M	
					—	—	—	—	—	—	WV-14M	WV-14M	WV-14M	WV-14M	
			400 W		—	—	—	—	—	—	WV-14M	WV-14M	WV-14M	WV-14M	
					—	—	—	—	—	—	WV-14M	WV-14M	WV-14M	WV-14M	
			600 W		—	—	—	—	—	—	WV-14M	—	WV-14M	WV-14M	
	750 W	—	—	—	—	—	—	—	—	WZ-19M	WZ-19M				
		—	—	—	—	—	—	—	—	WZ-19M	WZ-19M				
	Σ -X	Yaskawa Electric	Σ -X	50 W	\square 40	—	WQ-08K	WQ-08K	WQ-08K WQ-08M	WQ-08K WQ-08M	—	—	—	—	
						—	WQ-08K	WQ-08K	WQ-08K WQ-08M	WQ-08K WQ-08M	—	—	—	—	
				100 W		—	—	—	WQ-08K WQ-08M	WQ-08K WQ-08M	—	—	—	—	
						—	—	—	WQ-08K WQ-08M	WQ-08K WQ-08M	—	—	—	—	
				150 W		—	—	—	WQ-08K WQ-08M	WQ-08K WQ-08M	—	—	—	—	
						—	—	—	WQ-08K WQ-08M	WQ-08K WQ-08M	—	—	—	—	
				200 W		—	—	—	—	—	—	WV-14M	WV-14M	WV-14M	WV-14M
						—	—	—	—	—	—	WV-14M	WV-14M	WV-14M	WV-14M
400 W				—		—	—	—	—	—	WV-14M	WV-14M	WV-14M	WV-14M	
				—		—	—	—	—	—	WV-14M	—	WV-14M	WV-14M	
600 W	—	—	—	—	—	—	WV-14M	—	WV-14M	WV-14M					
	—	—	—	—	—	—	WV-14M	—	WV-14M	WV-14M					
750 W	—	—	—	—	—	—	—	—	WZ-19M	WZ-19M					
	—	—	—	—	—	—	—	—	WZ-19M	WZ-19M					

Motor type				Rated output	Flange size	KR										
						KR15	KR20	KR26	KR30H	KR33	KR45H	KR46	KR55	KR65		
AC servo motor	Mitsubishi Electric	MELSERVO	J4	HG-AK0136	10 W		WN-05D	WN-05D	WN-05D	—	—	—	—	—	—	
				HG-AK0236	20 W	□25	WN-05D	WN-05D	WN-05D	—	—	—	—	—	—	—
				HG-AK0336	30 W		WN-05D	WN-05D	WN-05D	—	—	—	—	—	—	—
			HG-MR053	50 W	□40	—	WQ-08D	WQ-08D	WQ-08D	WQ-08D	WQ-08D	—	—	—	—	—
			HG-KR053			—	WQ-08D	WQ-08D	WQ-08D	WQ-08D	WQ-08D	—	—	—	—	—
			HG-MR13	100 W	□40	—	—	—	WQ-08D	WQ-08D	—	—	—	—	—	
			HG-KR13			—	—	—	WQ-08D	WQ-08D	—	—	—	—	—	
			HG-MR23	200 W	□60	—	—	—	—	—	—	WV-14M	WV-14M	WV-14M	WV-14M	
			HG-KR23			—	—	—	—	—	—	WV-14M	WV-14M	WV-14M	WV-14M	
		HG-MR43	400 W	□60	—	—	—	—	—	—	WV-14M	WV-14M	WV-14M	WV-14M		
		HG-KR43			—	—	—	—	—	—	WV-14M	WV-14M	WV-14M	WV-14M		
		HG-MR73	750 W	□80	—	—	—	—	—	—	—	—	WZ-19M	WZ-19M		
		HG-KR73			—	—	—	—	—	—	—	—	—	WZ-19M	WZ-19M	
		J5	HK-KT053W	50 W	□40	—	WQ-08D	WQ-08D	WQ-08D	WQ-08D	WQ-08D	—	—	—	—	
			HK-KT13W	100 W		—	—	—	WQ-08D	WQ-08D	WQ-08D	—	—	—	—	
			HK-KT23W	200 W	□60	—	—	—	—	—	—	WV-14M	WV-14M	WV-14M	WV-14M	
			HK-KT43W	400 W		—	—	—	—	—	—	WV-14M	WV-14M	WV-14M	WV-14M	
			HK-KT7M3W	750 W	□80	—	—	—	—	—	—	—	—	WZ-19M	WZ-19M	
	JN		HF-KN053	50 W	□40	—	WQ-08D	WQ-08D	WQ-08D	WQ-08D	WQ-08D	—	—	—	—	
			HF-KN13	100 W		—	—	—	WQ-08D	WQ-08D	WQ-08D	—	—	—	—	
			HF-KN23	200 W	□60	—	—	—	—	—	—	WV-14M	WV-14M	WV-14M	WV-14M	
			HF-KN43	400 W		—	—	—	—	—	—	WV-14M	WV-14M	WV-14M	WV-14M	
	Tamagawa Seiki Co., Ltd.	TBL-II	TS4602	50 W	□40	—	WQ-08D	WQ-08D	WQ-08D	WQ-08D	WQ-08D	—	—	—	—	
			TS4603	100 W		—	—	—	WQ-08D	WQ-08D	WQ-08D	—	—	—	—	
			TS4604	150 W		—	—	—	WQ-08D	WQ-08D	WQ-08D	—	—	—	—	
			TS4607	200 W	□60	—	—	—	—	—	—	WV-14M	WV-14M	WV-14M	WV-14M	
			TS4609	400 W		—	—	—	—	—	—	WV-14M	WV-14M	WV-14M	WV-14M	
			TS4614	750 W		□80	—	—	—	—	—	—	—	WZ-19M	WZ-19M	
		TBL-IV	TSM3102	50 W	□40	—	WQ-08D	WQ-08D	WQ-08D	WQ-08D	WQ-08D	—	—	—	—	
			TSM3104	100 W		—	—	—	WQ-08D	WQ-08D	WQ-08D	—	—	—	—	
TSM3202			200 W	□60	—	—	—	—	—	—	WV-14M	—	WV-14M	WV-14M		
TSM3204			400 W		—	—	—	—	—	—	WV-14M	—	WV-14M	WV-14M		
TSM3303			600 W	□80	—	—	—	—	—	—	—	WV-14M	WZ-19M	WZ-19M		
TSM3304			750 W		—	—	—	—	—	—	—	WV-14M	WZ-19M	WZ-19M		

Motor type				Rated output	Flange size	KR											
						KR15	KR20	KR26	KR30H	KR33	KR45H	KR46	KR55	KR65			
AC servo motor	Panasonic Corp.	MINAS	A5	MSMD5A	50 W	□38	—	WP-08D WP-08K	WP-08D WP-08K	WP-08D WP-08K WP-08M	WP-08D WP-08K WP-08M	—	—	—	—		
				MSME5A			—	WP-08D WP-08K	WP-08D WP-08K	WP-08D WP-08K WP-08M	WP-08D WP-08K WP-08M	—	—	—	—		
				MSMD01			100 W	—	—	—	WP-08D WP-08K WP-08M	WP-08D WP-08K WP-08M	—	—	—	—	
				MSME01				—	—	—	WP-08D WP-08K WP-08M	WP-08D WP-08K WP-08M	—	—	—	—	
			MSMD02	200 W	□60	—	—	—	—	—	—	WY-11M	WY-11M	—	—		
			MSME02			—	—	—	—	—	WY-11M	WY-11M	—	—			
			MSMD04	400 W	□60	—	—	—	—	—	—	WY-14M	WY-14M	—	—		
			MSME04			—	—	—	—	—	WY-14M	WY-14M	—	—			
		MSMD08	750 W	□80	—	—	—	—	—	—	—	—	W5-19M	W5-19M			
		MSME08			—	—	—	—	—	—	—	W5-19M	W5-19M				
		Keyence Corporation	SV	A6	A5	MSMF5A	50 W	□38	—	WP-08K	WP-08K	WP-08K WP-08M	WP-08K WP-08M	—	—	—	—
						MHMF5A		□40	—	WQ-08K	WQ-08K	WQ-08K WQ-08M	WQ-08K WQ-08M	—	—	—	—
					MSMF01	100 W	□38	—	—	—	WP-08K WP-08M	WP-08K WP-08M	—	—	—	—	
					MHMF01		□40	—	—	—	WQ-08K WQ-08M	WQ-08K WQ-08M	—	—	—	—	
	MSMF02				200 W	□60	—	—	—	—	—	—	WY-11M	WY-11M	—	—	
	MHMF02						—	—	—	—	—	WY-11M	WY-11M	—	—		
	MSMF04				400 W	□60	—	—	—	—	—	—	WY-14M	WY-14M	—	—	
	MHMF04						—	—	—	—	—	WY-14M	WY-14M	—	—		
	MSMF08			750 W	□80	—	—	—	—	—	—	—	—	W5-19M	W5-19M		
	MHMF08					—	—	—	—	—	—	—	W5-19M	W5-19M			
	Keyence Corporation			SV	A6	SV-M005	50 W	□40	—	WQ-08K	WQ-08K	WQ-08K WQ-08M	WQ-08K WQ-08M	—	—	—	—
						SV-M010			100 W	—	—	—	WQ-08K WQ-08M	WQ-08K WQ-08M	—	—	—
						SV-M020	200 W	□60	—	—	—	—	—	WV-14M	WV-14M	WV-14M	WV-14M
						SV-M040			400 W	—	—	—	—	—	WV-14M	WV-14M	WV-14M
		SV-M075	750 W			□80	—	—	—	—	—	—	—	WZ-19M	WZ-19M		
		SV2	A6	SV2-M005	50 W	□40	—	WQ-08K	WQ-08K	WQ-08K WQ-08M	WQ-08K WQ-08M	—	—	—	—		
				SV2-M010			100 W	—	—	—	WQ-08K WQ-08M	WQ-08K WQ-08M	—	—	—	—	
				SV2-M020	200 W	□60	—	—	—	—	—	WV-14M	WV-14M	WV-14M	WV-14M		
SV2-M040				400 W			—	—	—	—	—	WV-14M	WV-14M	WV-14M	WV-14M		
SV2-M075				750 W	□80	—	—	—	—	—	—	—	WZ-19M	WZ-19M			

Motor type				Rated output	Flange size	KR								
						KR15	KR20	KR26	KR30H	KR33	KR45H	KR46	KR55	KR65
AC servo motor	SANYO DENKI	SANMOTION R	R2□A04005	50 W	□40	—	WQ-08K	WQ-08K	WQ-08M	WQ-08M	—	—	—	—
			R2EA04008	80 W		—	—	—	WQ-08M	WQ-08M	—	—	—	—
			R2□A04010	100 W		—	—	—	WQ-08M	WQ-08M	—	—	—	—
			R2□A06020	200 W	□60	—	—	—	—	—	WV-14M	WV-14M	WV-14M	WV-14M
			R2AA06040	400 W		—	—	—	—	WV-14M	WV-14M	WV-14M	WV-14M	
			R2AA08075	750 W	□80	—	—	—	—	—	—	—	WZ-16M	WZ-16M
	Omron	OMNUC G5	R88M-K05030	50 W	□40	—	WQ-08K	WQ-08K	WQ-08K WQ-08M	WQ-08K WQ-08M	—	—	—	—
			R88M-K10030	100 W		—	—	—	WQ-08K WQ-08M	WQ-08K WQ-08M	—	—	—	—
			R88M-K20030	200 W	□60	—	—	—	—	—	WY-11M	WY-11M	—	—
			R88M-K40030	400 W		—	—	—	—	—	WY-14M	WY-14M	—	—
			R88M-K75030	750 W	□80	—	—	—	—	—	—	—	W5-19M	W5-19M
		1S	R88M-1M10030	100 W	□40	—	—	—	WQ-08K WQ-08M	WQ-08K WQ-08M	—	—	—	—
			R88M-1M20030	200 W	□60	—	—	—	—	—	WY-11M	WY-11M	—	—
			R88M-1M40030	400 W		—	—	—	—	—	WY-14M	WY-14M	—	—
			R88M-1M75030	750 W	□80	—	—	—	—	—	—	—	W5-19M	W5-19M
		Fanuc	β is series	βis0.2/5000	50 W	□40	—	WQ-08K	WQ-08K	—	—	—	—	—

Note 1) The symbols in the table indicate the housing A and intermediate flange.

Note 2) For the motor coupling, contact THK.

Note 3) The motor types in the table represent only some of the types available. For details regarding different types, please see the catalog from each respective motor manufacturer.

Note 4) Model KR15 has a limit in input torque. The permissible input torque for model KR1501 is 0.051 N·m at a maximum, and that for model KR1502 is 0.103 N·m at a maximum. If the maximum torque of the motor mounted to model KR15 exceeds the permissible input torque, take a safety measure such as setting a torque limit.

[Dimensional Drawing of Housing A/Intermediate Flange for Model KR]

● For Model KR15

KR**	··· Actuator model number
●◇	···●: Housing A ◇: Intermediate flange

■ Housing A

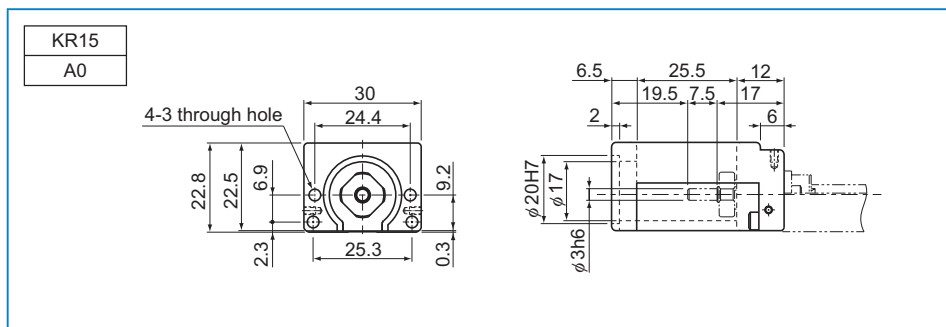

■ Intermediate Flange

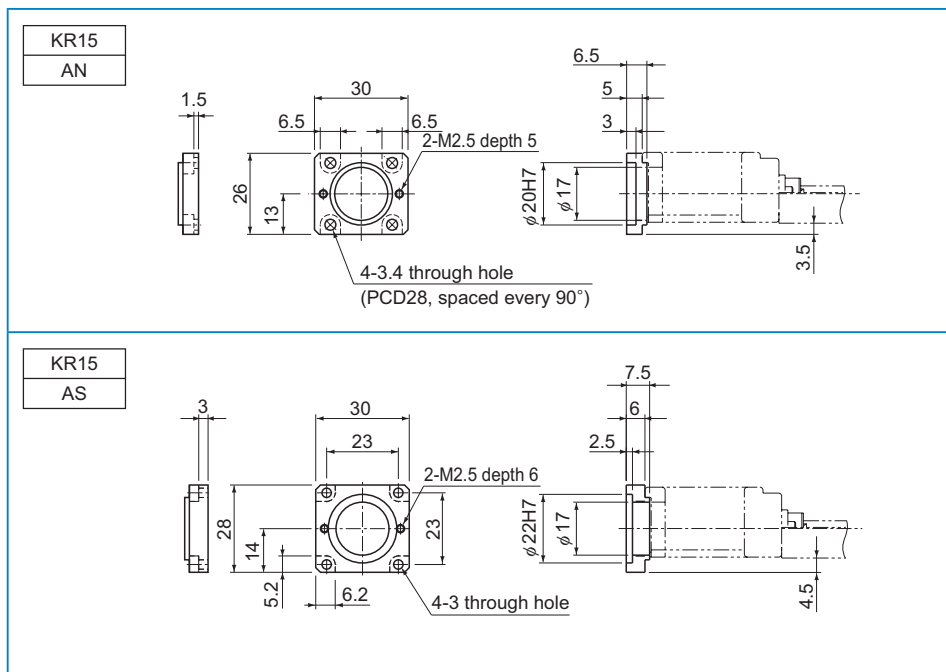

■ Motor Wrap Housing A

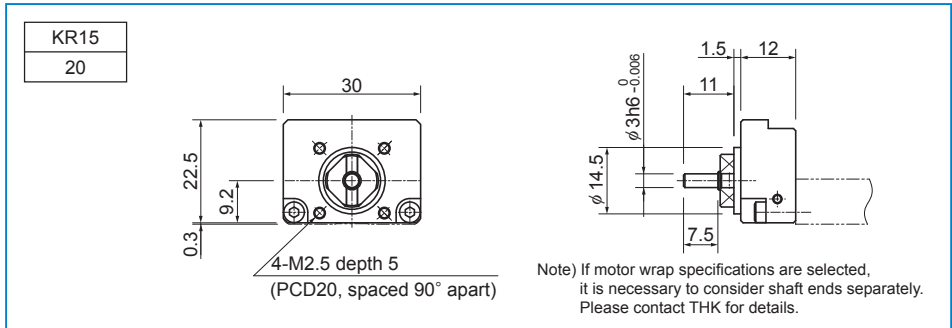

KR**	...Actuator model number
W□	...□: Intermediate flange

■ Motor Wrap Specifications (Intermediate Flange)

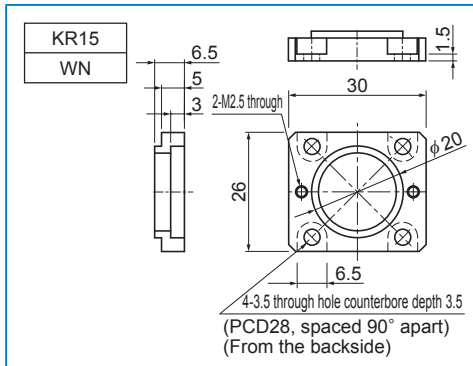

● For Model KR20

KR**	··· Actuator model number
●◇	··· ●: Housing A ◇: Intermediate flange

■ Housing A

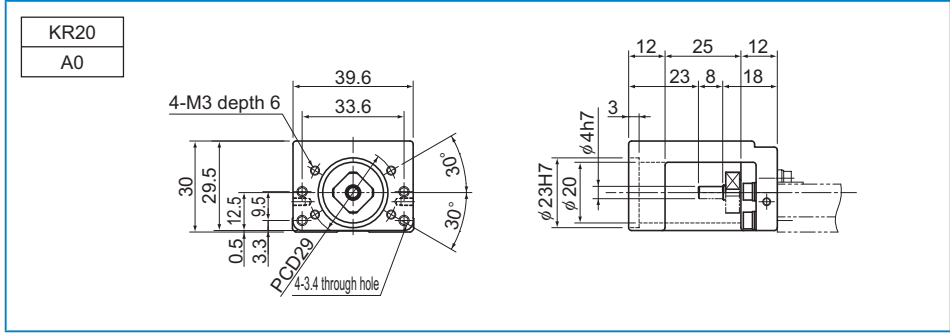

■ Intermediate Flange

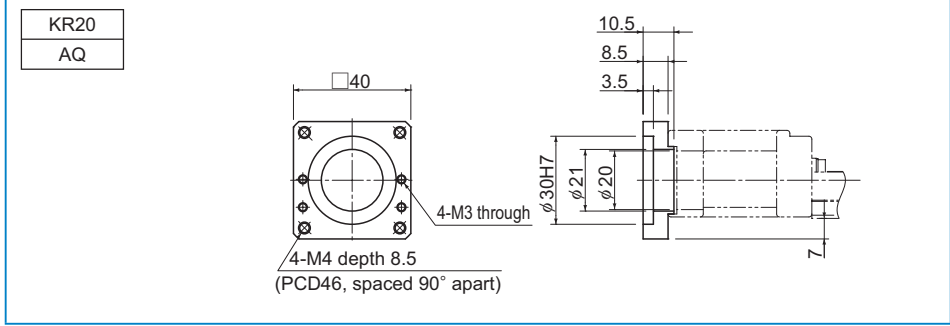
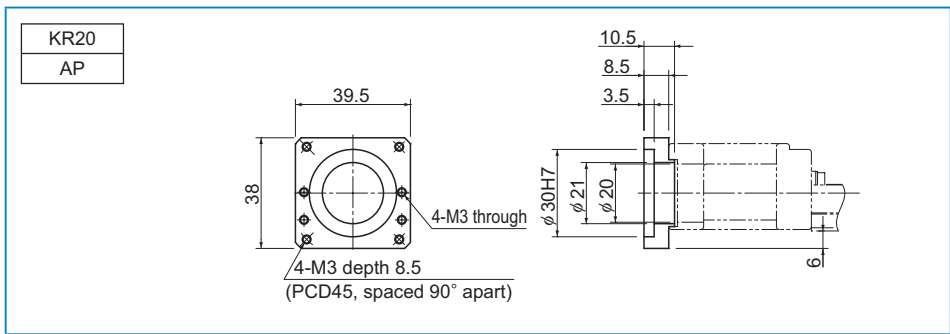

LM Guide Actuator (Options)

KR20

AR

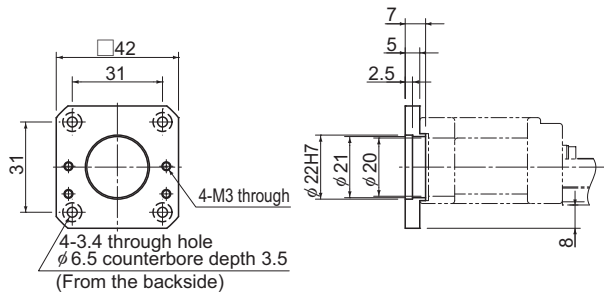

KR20

AS

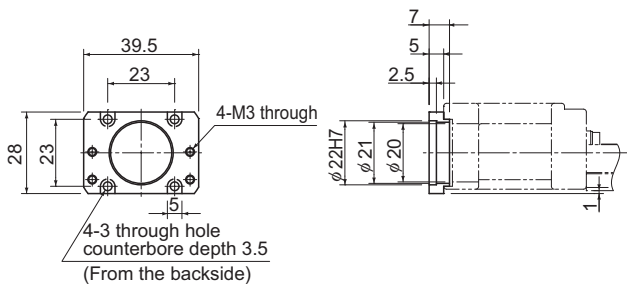

KR20

AN

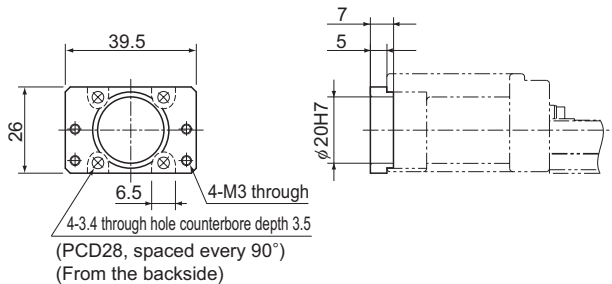

Motor Wrap Housing A

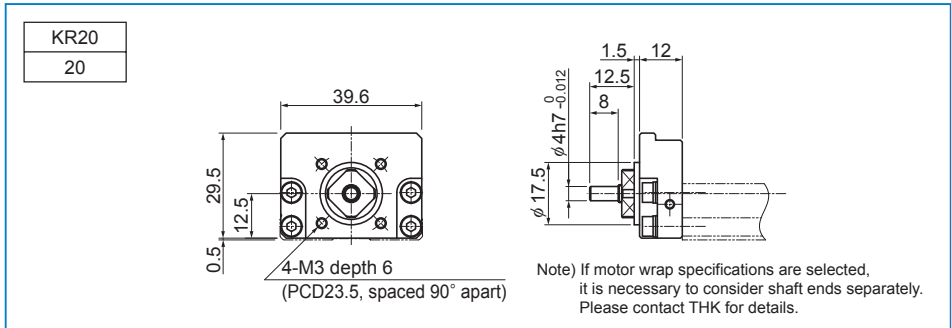

KR**	... Actuator model number
W□	... □: Intermediate flange

Motor Wrap Specifications (Intermediate Flange)

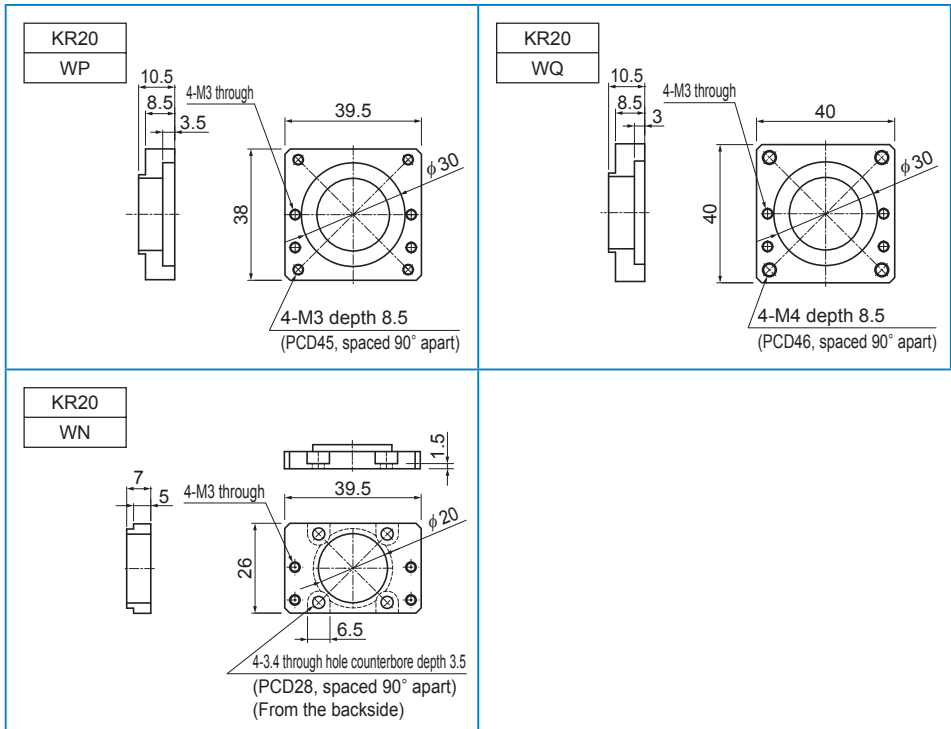

● For Model KR26

KR**	···· Actuator model number
● ◆	····●: Housing A
◆	◆: Intermediate flange

■ Housing A

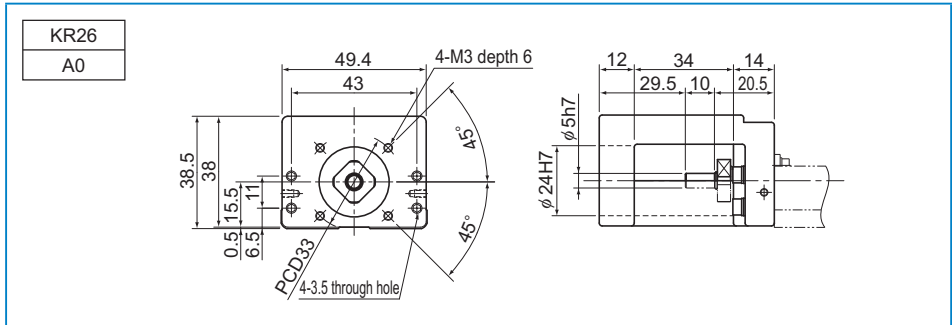

■ Intermediate Flange

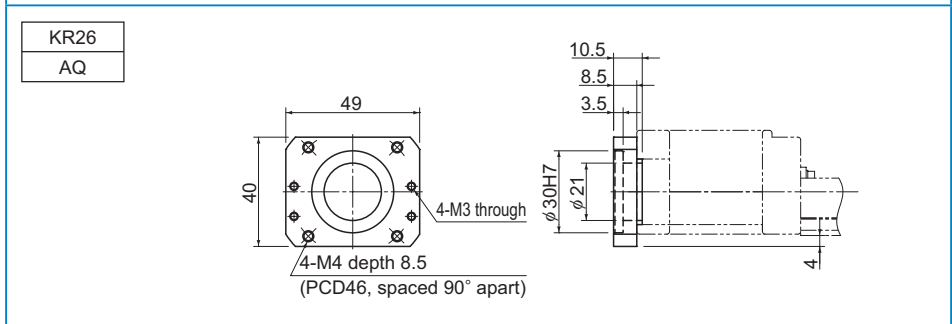
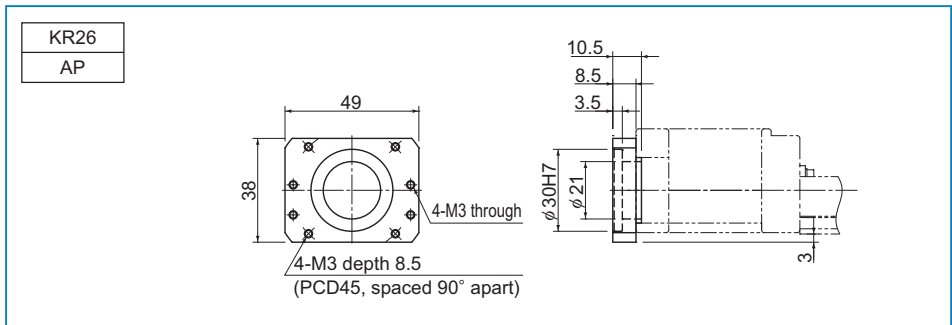

KR26

AR

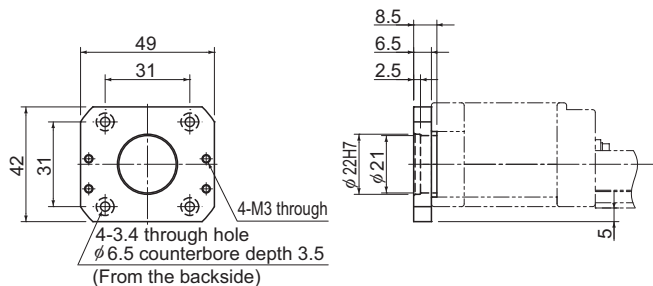

KR26

AS

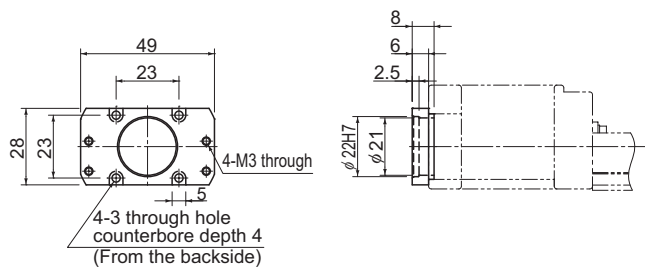

KR26

AN

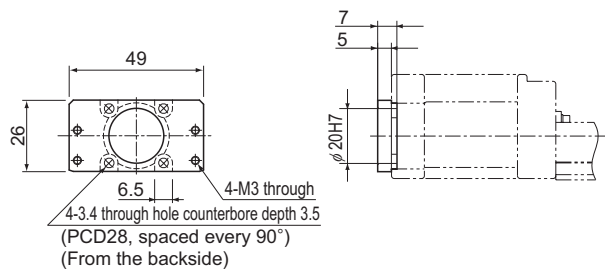

Motor Wrap Housing A

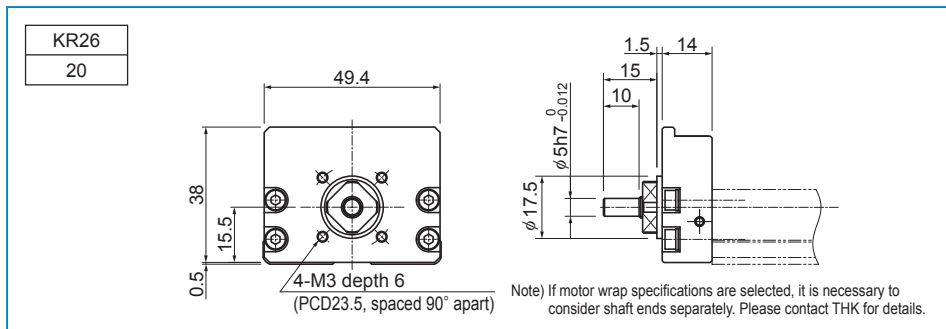

KR**	...Actuator model number
W□	...□: Intermediate flange

Motor Wrap Specifications (Intermediate Flange)

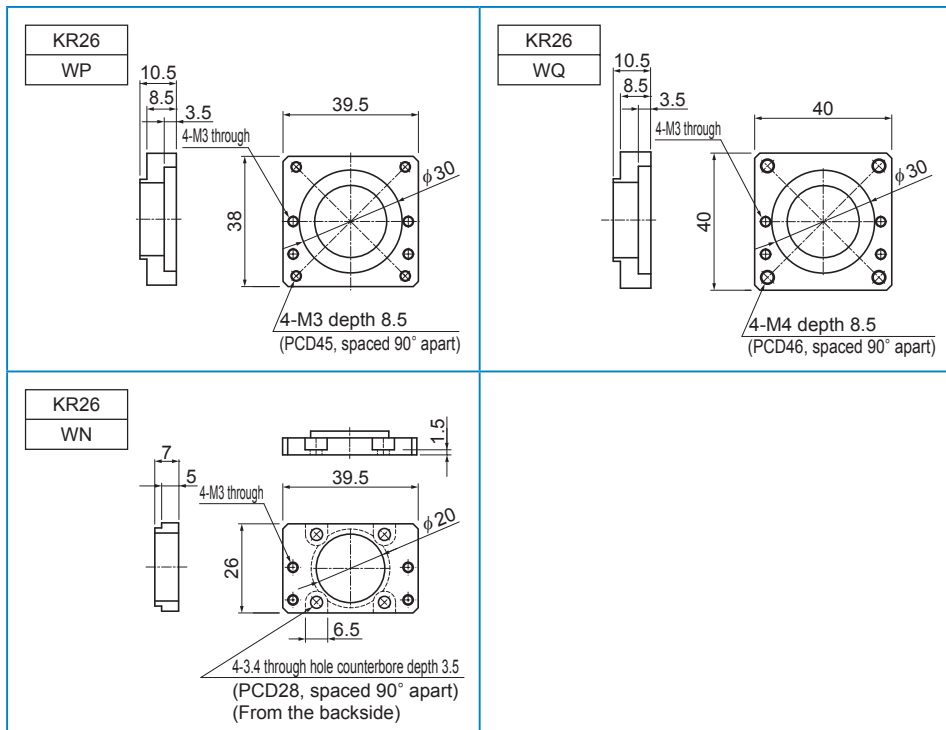

■Motor Wrap Housing A

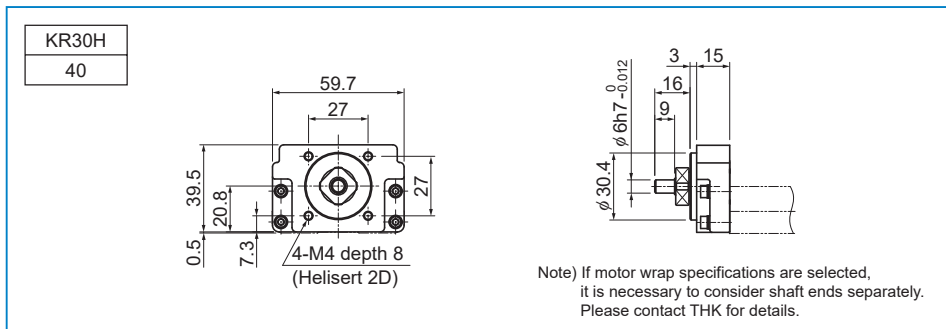

KR**	... Actuator model number
W□	... □: Intermediate flange

■Motor Wrap Specifications (Intermediate Flange)

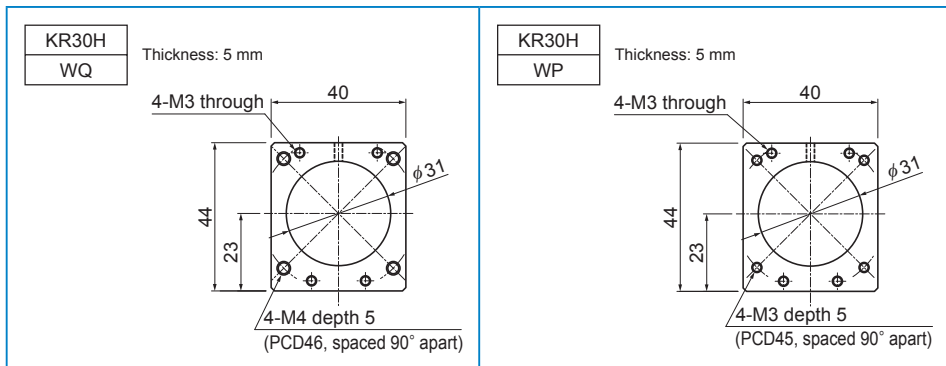

● For Model KR33

KR**	···· Actuator model number
● ◇	····●: Housing A ◇: Intermediate flange

■ Housing A

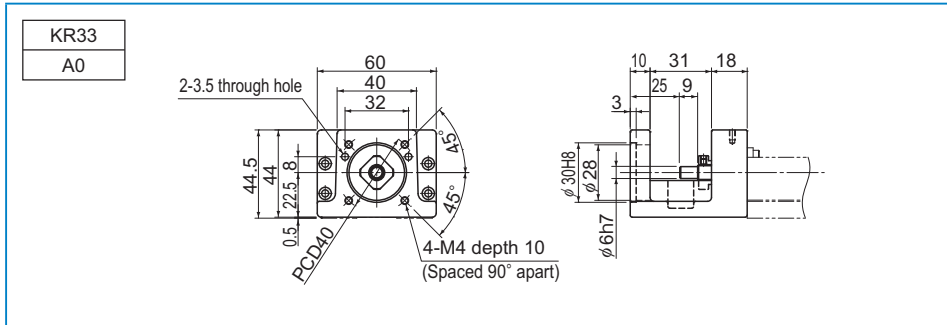

■ Intermediate Flange

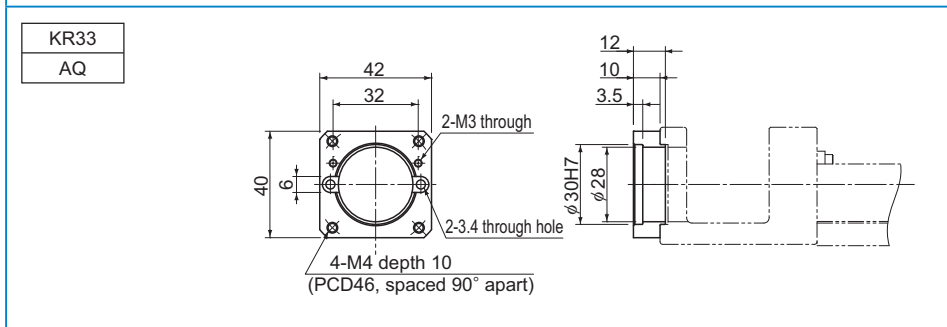
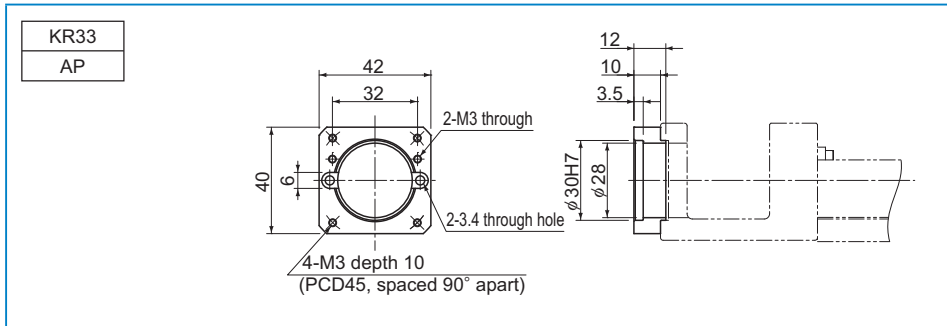

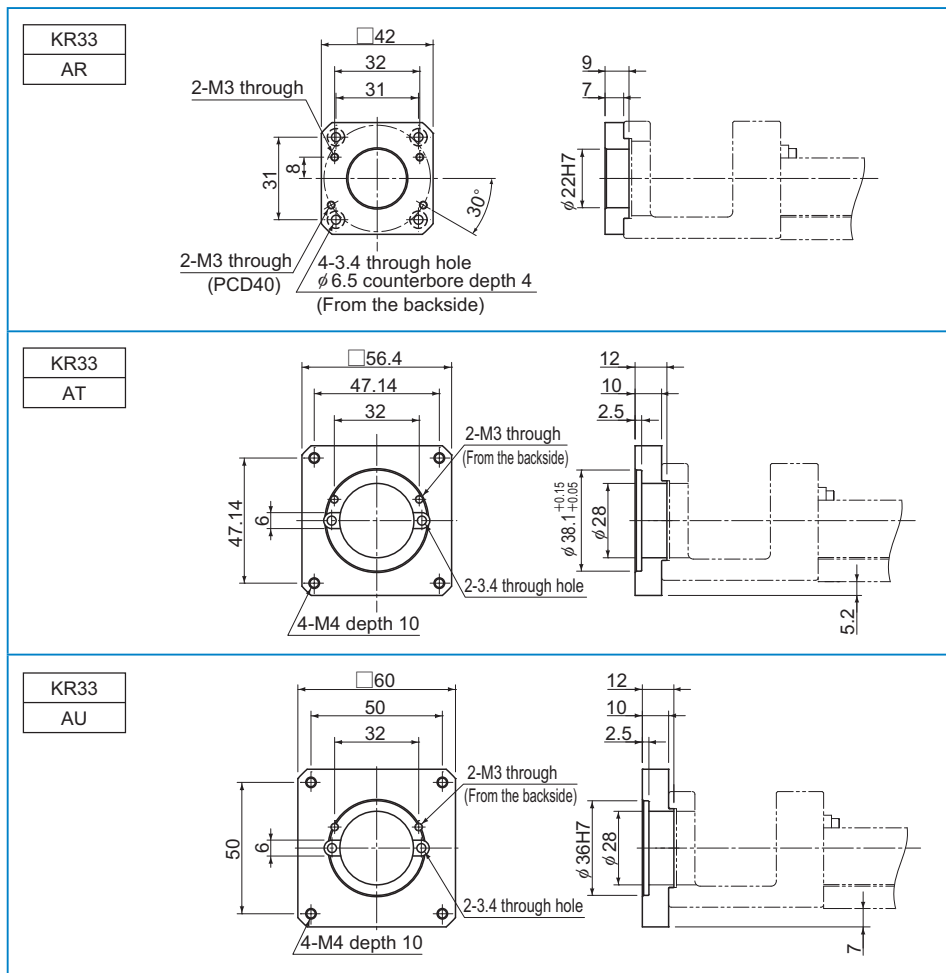

Motor Wrap Housing A

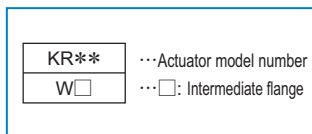
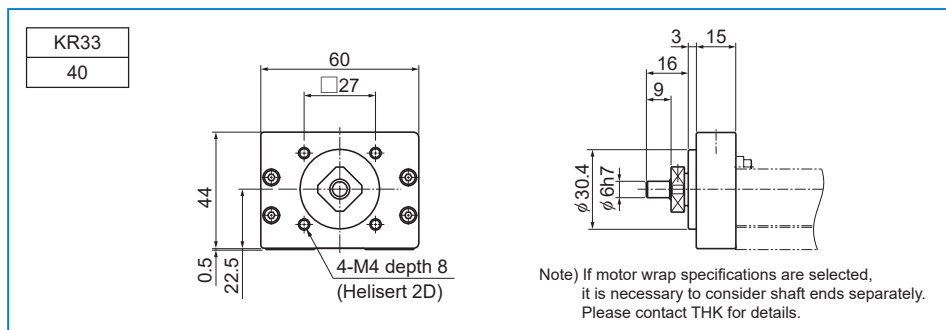

Motor Wrap Specifications (Intermediate Flange)

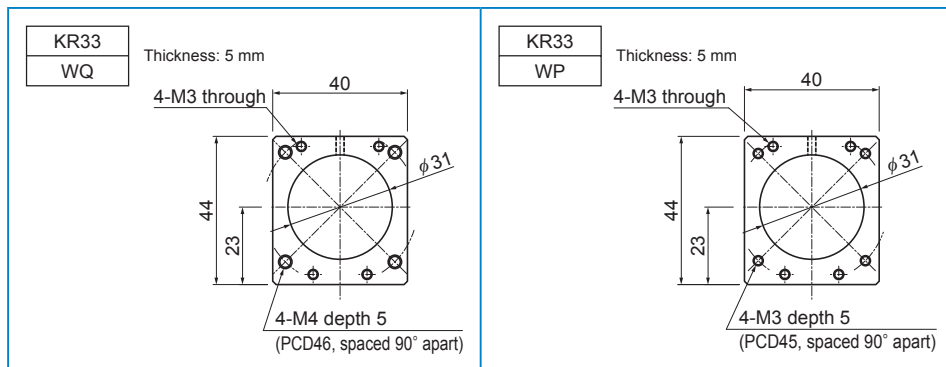

● For Model KR45H

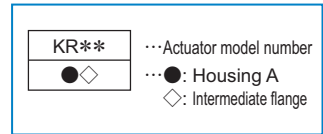

■ Housing A

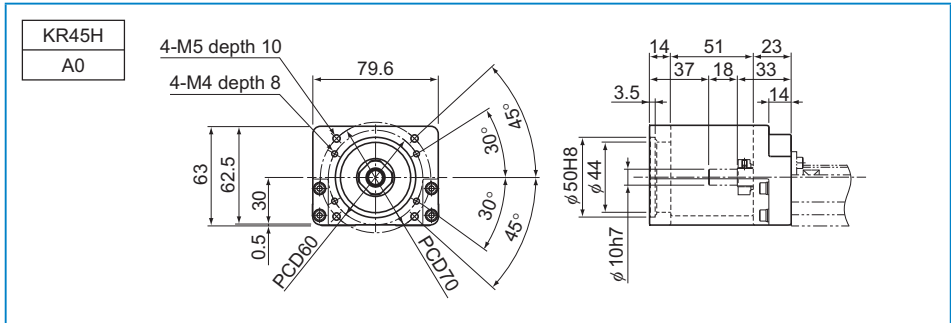

■ Intermediate Flange

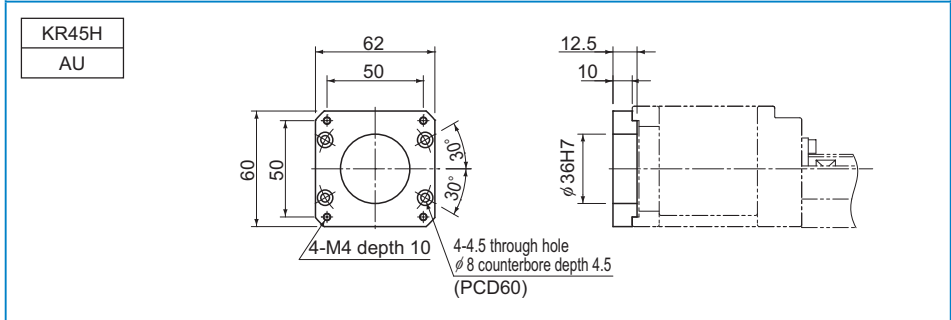
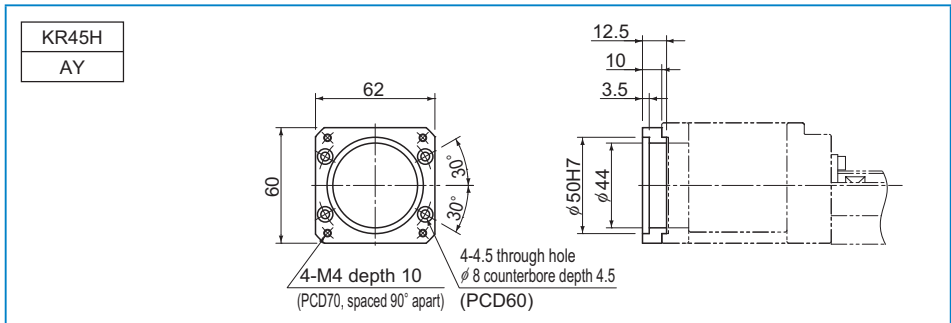

Motor Wrap Housing A

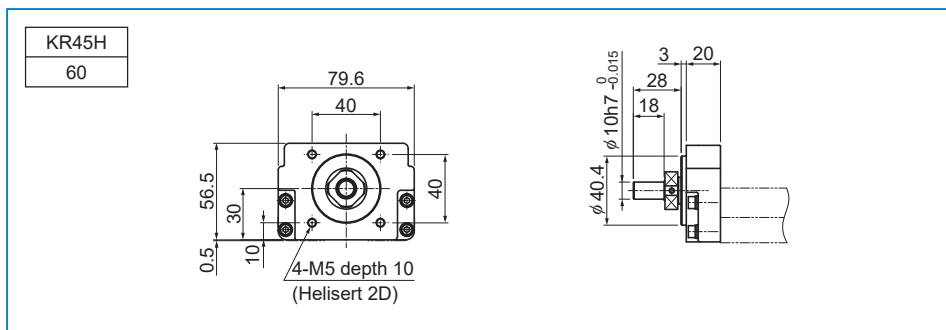

KR**	... Actuator model number
W□	... □: Intermediate flange

Motor Wrap Specifications (Intermediate Flange)

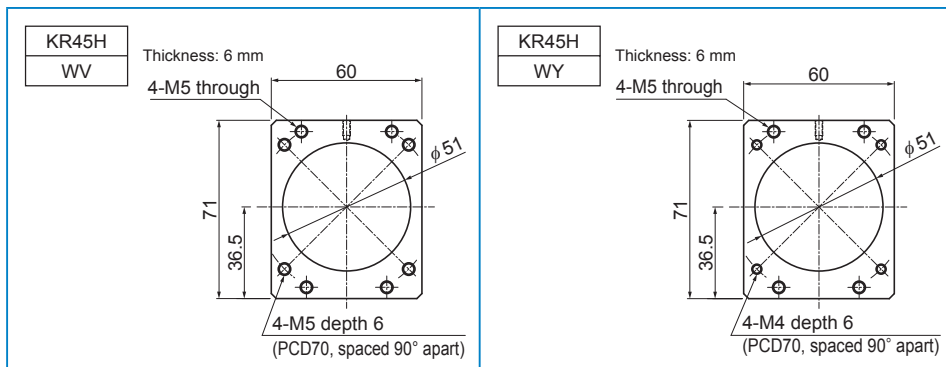

● For Model KR46

KR**	···· Actuator model number
●◇	····: Housing A ◇: Intermediate flange

■ Housing A

KR46 A0		
KR46 10		
KR46 30		

LM Guide Actuator (Options)

KR46

40

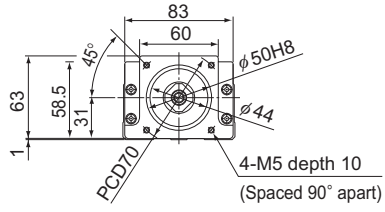

Motor Wrap Housing A

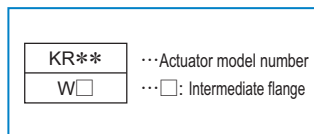
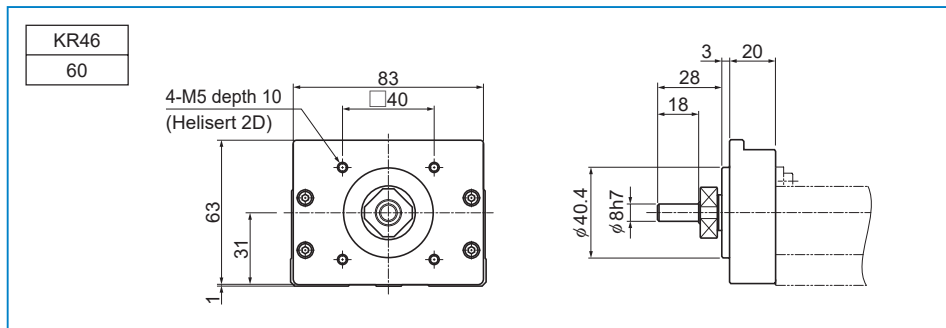

Motor Wrap Specifications (Intermediate Flange)

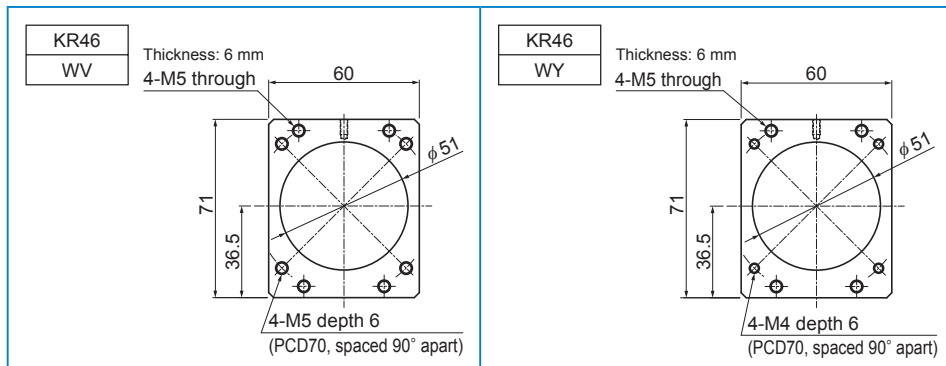

● For Model KR55

KR**	··· Actuator model number
●◇	···●: Housing A
	◇: Intermediate flange

■ Housing A

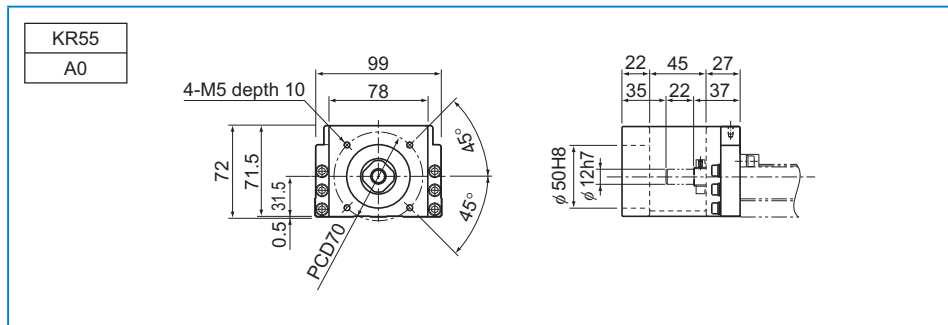

■ Intermediate Flange

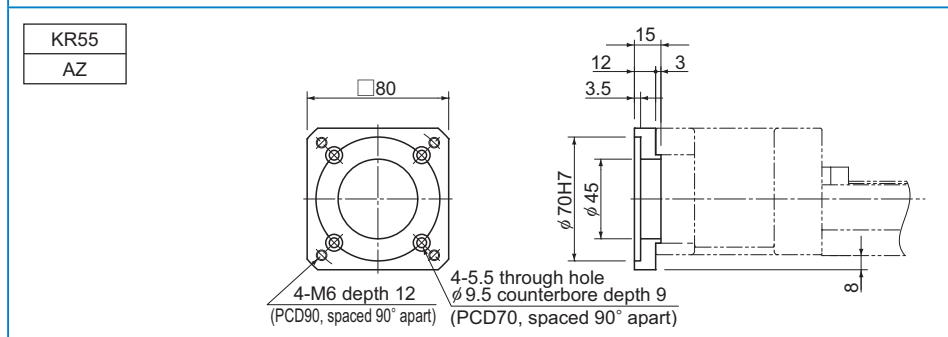
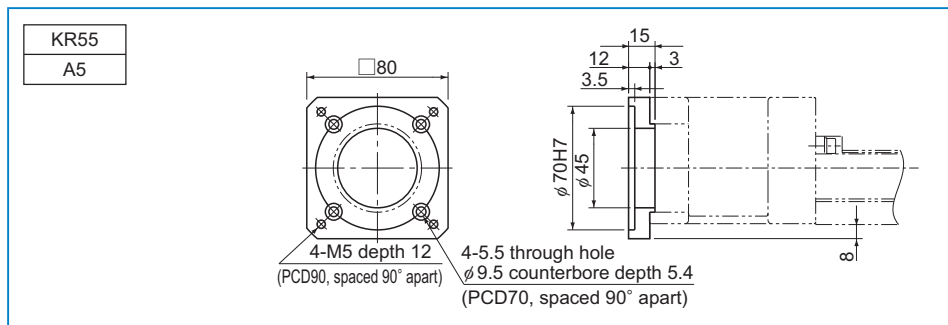

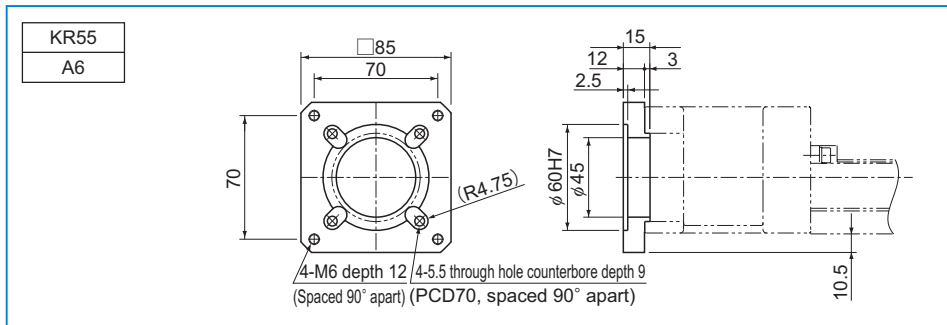

Motor Wrap Housing A

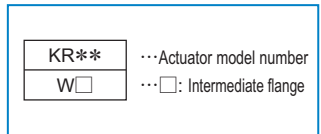
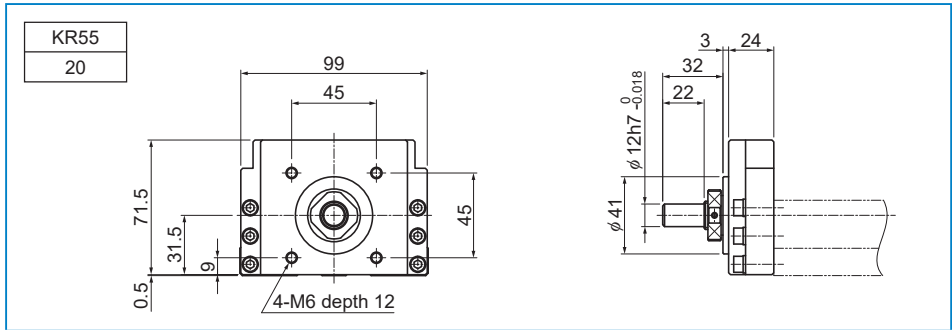

Motor Wrap Specifications (Intermediate Flange)

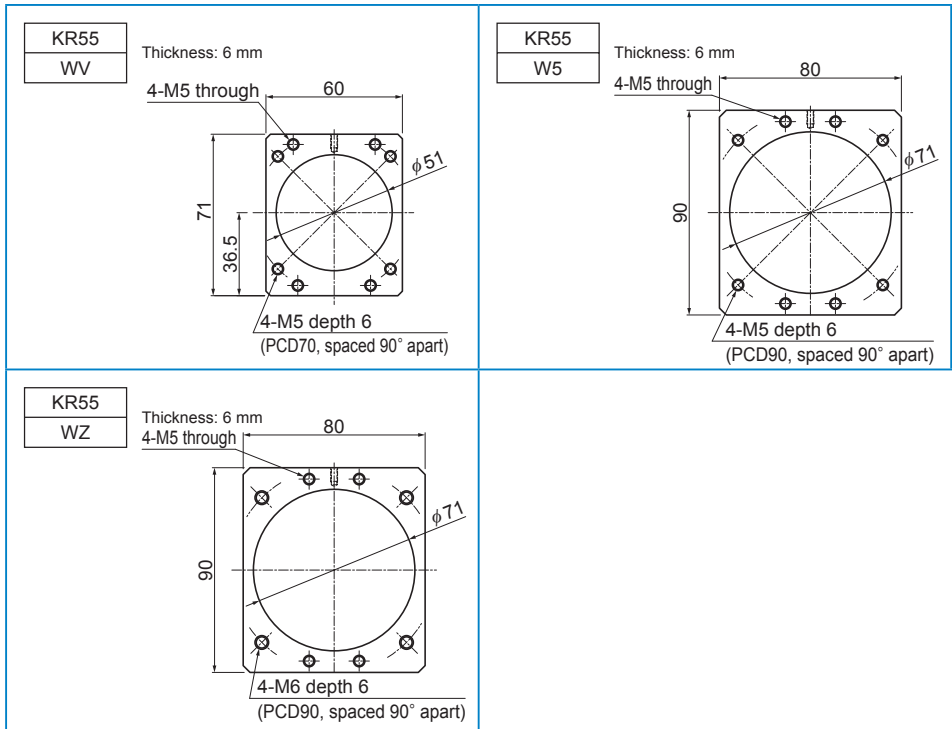

● For Model KR65

KR**	··· Actuator model number
●◇	··· ●: Housing A ◇: Intermediate flange

■ Housing A

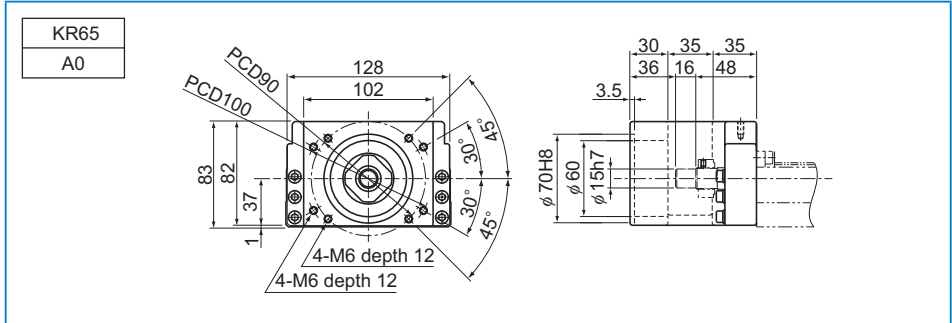

■ Intermediate Flange

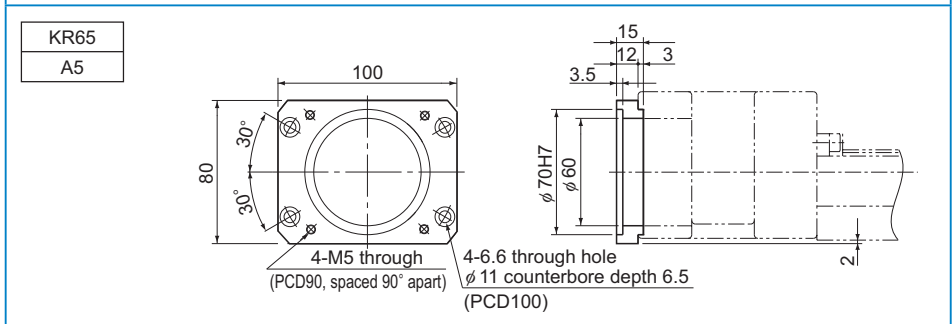
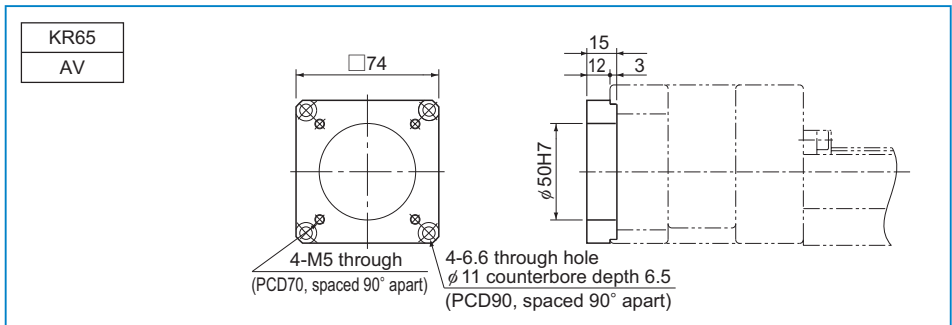

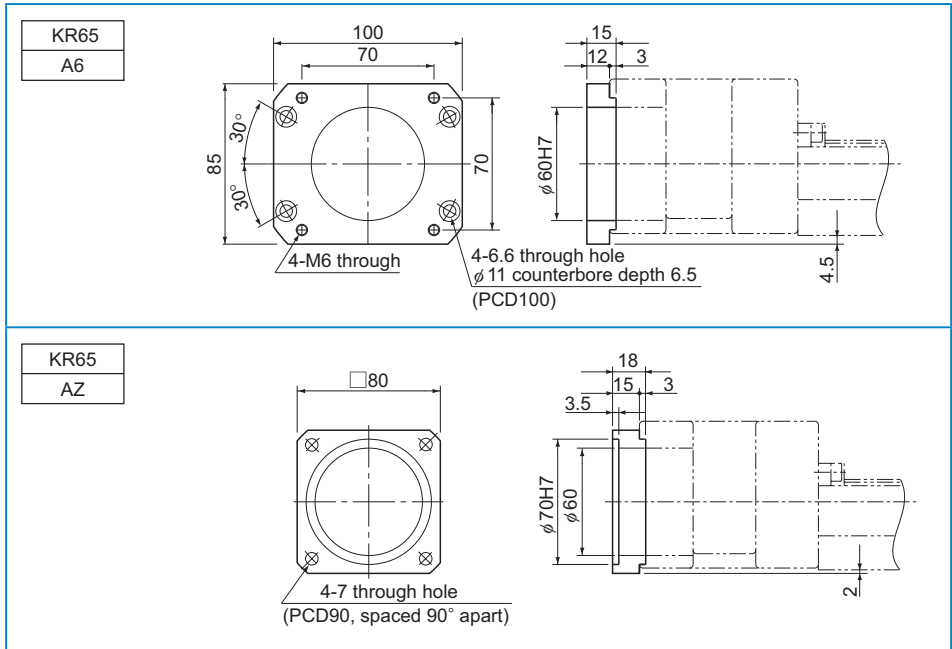

Motor Wrap Housing A

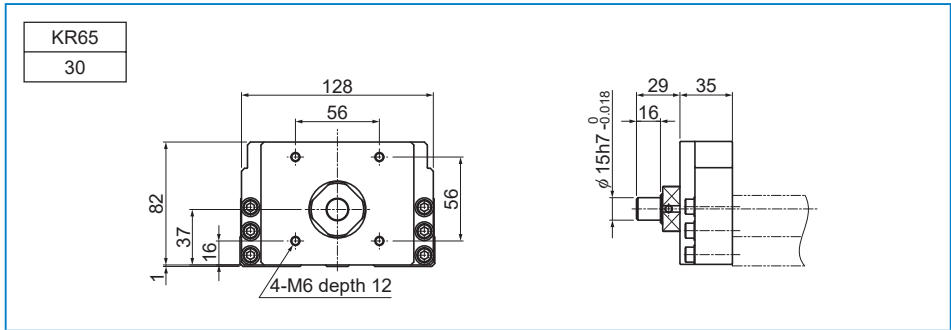

KR**	··· Actuator model number
W□	··· □: Intermediate flange

Motor Wrap Specifications (Intermediate Flange)

