

## XY Bracket (for Reference)

Brackets for installing models SKR33/46 and models KR33/46 only are available. The brackets use aluminum to reduce the weight and keep inertia as low as possible.

[KR-008XS (for Model KR33, Single-Shaft Type, and for Model SKR33, without Cover, Single-Shaft Type)]

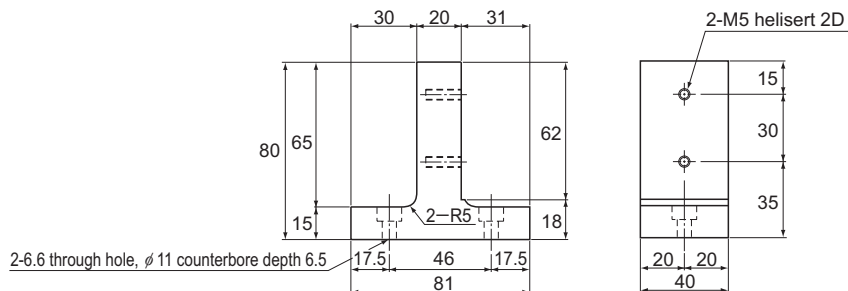

[KR-008XL (for Model KR46, Single-Shaft Type, and for Model SKR46, Single-Shaft Type)]

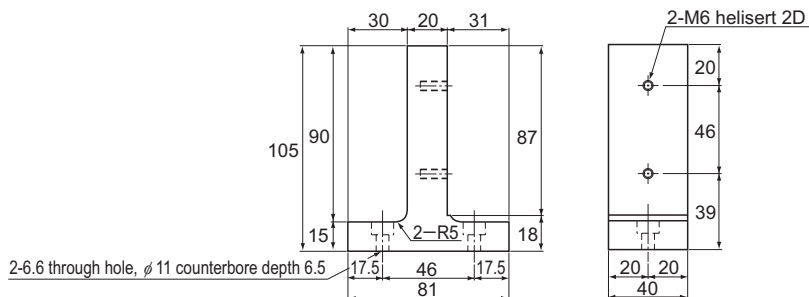

[KR-003XS (for Model KR33, Outer Rail Fixed, and for Model SKR33, without Cover, Outer Rail Fixed)]

**KR46A+KR33A**

**SKR46A+SKR33A**  
Without cover

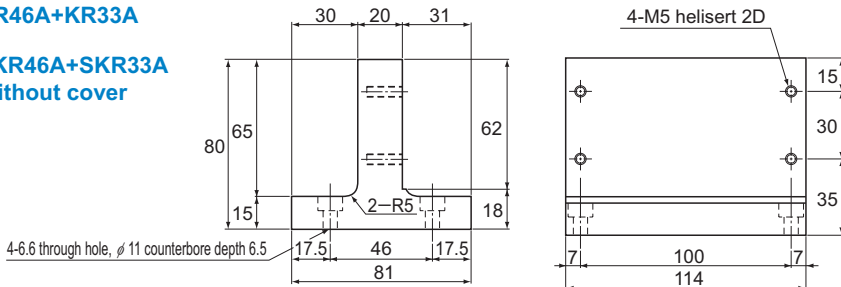

[KR-003XL (for Model KR46, Outer Rail Fixed, and for Model SKR46, Outer Rail Fixed)]

**KR46A+KR46A**

**SKR46A+SKR46A**

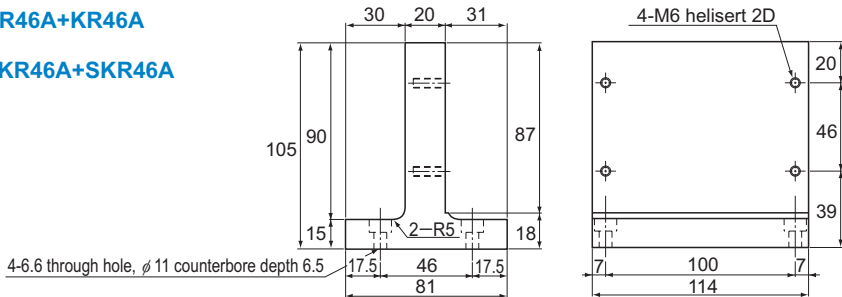

[KR-002XS (for Model KR33, Slider Fixed, and for Model SKR33, with Cover, Slider Fixed)]

**KR46A+KR33A**

**SKR46A+SKR33A**  
With a cover

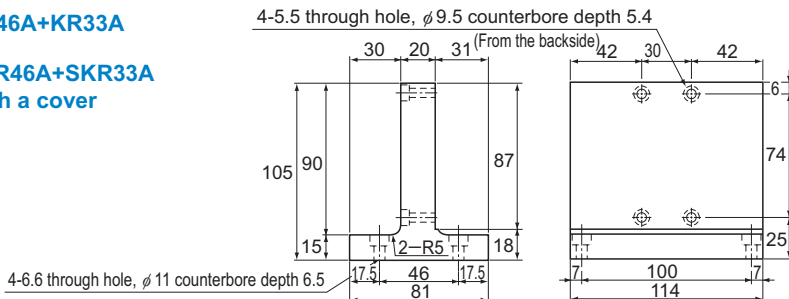

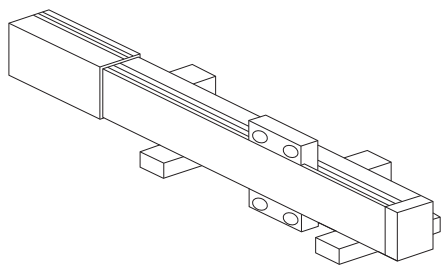
**[Example Combinations]**

Single shaft

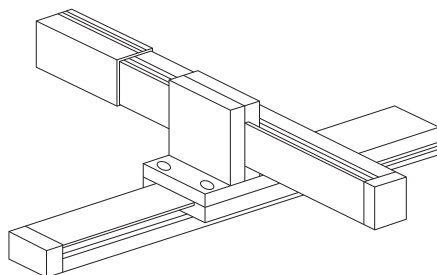

Fixed slider

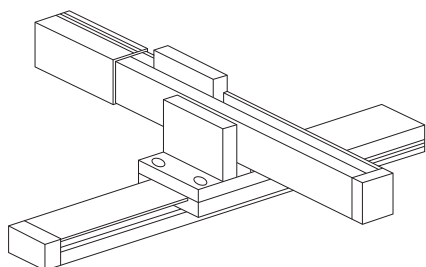

Fixed outer rail

