

Models RSR-M1WV and RSR-M1WN

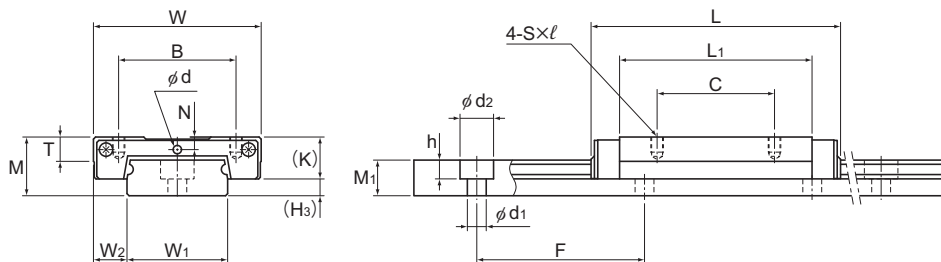

Models RSR9 and 12M1WV/M1WN

Model No.	Outer dimensions			LM block dimensions										H _s
	Height	Width	Length	B	C	S × ℓ	L ₁	T	K	N	E	Lubrication hole d	Grease nipple	
	M	W	L	B	C	S × ℓ	L ₁	T	K	N	E	d		H _s
RSR 9M1WV RSR 9M1WN	12	30	39 50.7	21 23	12 24	M2.6×3 M3×3	27 38.7	—	7.8	2	—	1.6	—	4.2
RSR 12M1WV RSR 12M1WN	14	40	44.5 59.5	28	15 28	M3×3.5	30.9 45.9	4.5	10	3	—	2	—	4
RSR 15M1WV RSR 15M1WN	16	60	55.5 74.5	45	20 35	M4×4.5	38.9 57.9	5.6	12	3.5	3	—	PB107	4

Model number coding

2 RSR12 M1 WN UU C1 +310L P T

2	RSR12	M1	WN	UU	C1	+310L	P	T
Model number	Type of LM block	Contamination protection accessory symbol (*2)	LM rail length (in mm)	Symbol for LM rail jointed use	Accuracy symbol (*4)	Normal grade (No Symbol)/High accuracy grade (H)	Precision grade (P)	Precision grade (P)
No. of LM blocks used on the same rail (*1)	Symbol for high temperature type LM Guide	Radial clearance symbol (*3) Normal (No symbol) Light preload (C1)						

(*1) No symbol for 1 LM block.

(*2) See contamination protection accessories on **A1-543**. (*3) See **A1-74**. (*4) See **A1-85**.

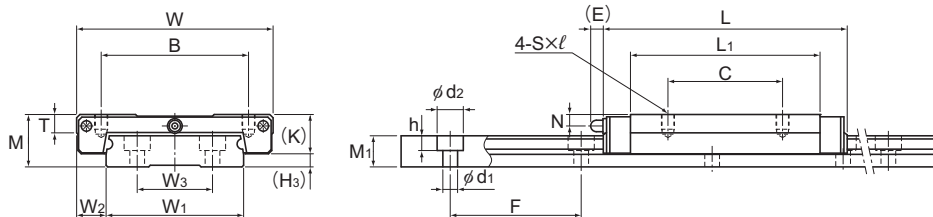

Models RSR15M1WV/M1WN

Unit: mm

LM rail dimensions							Basic load rating		Static permissible moment N·m*					Mass	
Width W_1	W_2	W_3	Height M_1	Pitch F	Length* $d_1 \times d_2 \times h$	Max	C kN	C_0 kN	M_A		M_B		M_C	LM block kg	LM rail kg/m
									1 block	Double blocks	1 block	Double blocks	1 block		
18	6	—	7.5	30	3.5 × 6 × 4.5	1430	2.45 3.52	3.92 5.37	16 31	92.9 161	16 31	92.9 161	36 49.4	0.035 0.051	1.08
24	8	—	8.5	40	4.5 × 8 × 4.5	1600	4.02 5.96	6.08 9.21	24.5 53.9	138 274	21.7 47.3	123 242	59.5 90.1	0.075 0.101	1.5
42	9	23	9.5	40	4.5 × 8 × 4.5	1800	6.66 9.91	9.8 14.9	50.3 110	278 555	44.4 97.3	248 490	168 255	0.17 0.21	3

Note1) The maximum length under "Length*" indicates the standard maximum length of an LM rail. (See [A1-394](#).)

Static permissible moment* 1 block: the static permissible moment with one LM block

Double blocks: static permissible moment when two LM blocks are in close contact with each other

Total block length L

: The total block length L shown in the table is the length with the dust-proof parts (code: UU).

Please be aware that balls will fall out if the LM block is removed from the LM rail.

Note2) The basic load rating in the dimension table is for a load in the radial direction. Use Table 7 on [A1-61](#) to calculate the load rating for loads in the reverse radial direction or lateral direction.