

BIF-V Medium With Preload

| | |
|----------|--------|
| DN value | 130000 |
|----------|--------|

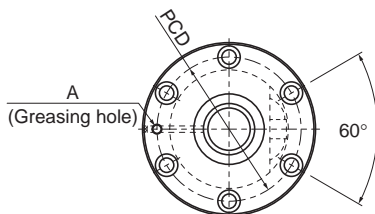

| Model No. | Screw shaft outer diameter d | Lead Ph | Ball center-to-center diameter dp | Thread minor diameter dc | No. of loaded circuits Rows X turns | Basic load rating | | Rigidity K N/μm |
|--------------|---------------------------------|------------|--------------------------------------|-----------------------------|--|-------------------|-----------------------|-----------------------|
| | | | | | | Ca kN | C _{0a} kN | |
| BIF 2508V-5 | 25 | 8 | 26.25 | 20.5 | 1×2.5 | 15.8 | 32.9 | 500 |
| BIF 2508V-7 | 25 | 8 | 26.25 | 20.5 | 1×3.5 | 21.1 | 46 | 688 |
| BIF 2508V-10 | 25 | 8 | 26.25 | 20.5 | 2×2.5 | 28.7 | 65.7 | 968 |
| BIF 2510V-5 | 25 | 10 | 26.25 | 21.5 | 1×2.5 | 15.8 | 32.9 | 500 |
| BIF 2810V-3 | 28 | 10 | 29.75 | 22.4 | 1×1.5 | 15.6 | 29.4 | 350 |
| BIF 3210V-5 | 32 | 10 | 33.75 | 26.4 | 1×2.5 | 26 | 56.2 | 640 |
| BIF 3210V-7 | 32 | 10 | 33.75 | 26.4 | 1×3.5 | 34.8 | 78.6 | 874 |
| BIF 3210V-10 | 32 | 10 | 33.75 | 26.4 | 2×2.5 | 47.3 | 112.3 | 1128 |
| BIF 3212V-5 | 32 | 12 | 34 | 26.1 | 1×2.5 | 30.2 | 63.2 | 644 |
| BIF 3212V-7 | 32 | 12 | 34 | 26.1 | 1×3.5 | 40.4 | 88.5 | 888 |
| BIF 3216V-5 | 32 | 16 | 33.75 | 26.4 | 1×2.5 | 25.9 | 56.5 | 636 |
| BIF 3610V-5 | 36 | 10 | 37.75 | 30.5 | 1×2.5 | 27.6 | 63.3 | 696 |
| BIF 3610V-7 | 36 | 10 | 37.75 | 30.5 | 1×3.5 | 36.9 | 88.6 | 700 |
| BIF 3610V-10 | 36 | 10 | 37.75 | 30.5 | 2×2.5 | 50.1 | 126.5 | 1350 |
| BIF 3612V-5 | 36 | 12 | 38 | 30.1 | 1×2.5 | 32.2 | 71.2 | 708 |
| BIF 3612V-7 | 36 | 12 | 38 | 30.1 | 1×3.5 | 43 | 99.6 | 976 |
| BIF 3612V-10 | 36 | 12 | 38 | 30.1 | 2×2.5 | 58.4 | 142.3 | 1372 |
| BIF 3616V-5 | 36 | 16 | 38 | 30.1 | 1×2.5 | 32.1 | 71.5 | 710 |
| BIF 3620V-3 | 36 | 20 | 37.75 | 30.5 | 1×1.5 | 17.7 | 38.4 | 430 |
| BIF 4010V-5 | 40 | 10 | 41.75 | 34.4 | 1×2.5 | 29 | 70.4 | 750 |
| BIF 4010V-7 | 40 | 10 | 41.75 | 34.4 | 1×3.5 | 38.8 | 98.5 | 1044 |
| BIF 4010V-10 | 40 | 10 | 41.75 | 34.4 | 2×2.5 | 52.7 | 140.7 | 1470 |
| BIF 4012V-5 | 40 | 12 | 42 | 34.1 | 1×2.5 | 33.9 | 79.2 | 770 |
| BIF 4012V-7 | 40 | 12 | 42 | 34.1 | 1×3.5 | 45.3 | 110.8 | 1062 |
| BIF 4012V-10 | 40 | 12 | 42 | 34.1 | 2×2.5 | 61.6 | 158.3 | 1490 |
| BIF 4016V-5 | 40 | 16 | 42 | 34.1 | 1×2.5 | 33.9 | 79.4 | 772 |
| BIF 4020V-5 | 40 | 20 | 41.75 | 34.4 | 1×2.5 | 28.9 | 71 | 760 |

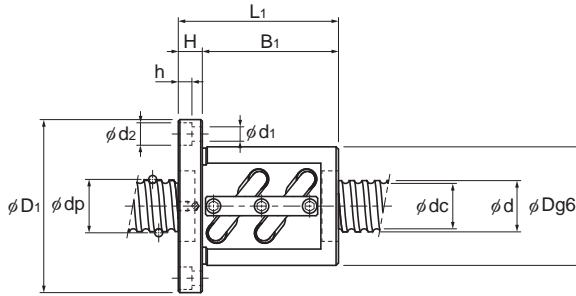

Unit: mm

| | Nut dimensions | | | | | | | | Screw shaft inertial moment/mm ³ | Nut mass | Shaft mass | Maximum permissible rotation speed |
|--|----------------|-----------------|----------------|----|----------------|-----|-------------------------------------|---------------|---|----------|------------|------------------------------------|
| | Outer diameter | Flange diameter | Overall length | | | | | Greasing hole | | | | |
| | D | D ₁ | L ₁ | H | B ₁ | PCD | d ₁ × d ₂ × h | A | | | | |
| | 58 | 85 | 82 | 15 | 67 | 71 | 6.6 × 11 × 6.5 | M6 | 3.01 × 10 ⁻⁷ | 1.52 | 3.51 | 4950 |
| | 58 | 85 | 98 | 15 | 83 | 71 | 6.6 × 11 × 6.5 | M6 | 3.01 × 10 ⁻⁷ | 1.5 | 3.51 | 4950 |
| | 58 | 85 | 130 | 15 | 115 | 71 | 6.6 × 11 × 6.5 | M6 | 3.01 × 10 ⁻⁷ | 1.93 | 3.51 | 4950 |
| | 58 | 85 | 100 | 18 | 82 | 71 | 6.6 × 11 × 6.5 | M6 | 3.01 × 10 ⁻⁷ | 1.31 | 3.5 | 4950 |
| | 65 | 106 | 88 | 18 | 70 | 85 | 11 × 17.5 × 11 | M6 | 4.74 × 10 ⁻⁷ | 2.33 | 4.15 | 4360 |
| | 74 | 108 | 100 | 15 | 85 | 90 | 9 × 14 × 8.5 | M6 | 8.08 × 10 ⁻⁷ | 2.92 | 5.53 | 3850 |
| | 74 | 108 | 120 | 15 | 105 | 90 | 9 × 14 × 8.5 | M6 | 8.08 × 10 ⁻⁷ | 3.1 | 5.53 | 3850 |
| | 74 | 108 | 160 | 15 | 145 | 90 | 9 × 14 × 8.5 | M6 | 8.08 × 10 ⁻⁷ | 4.27 | 5.53 | 3850 |
| | 76 | 121 | 117 | 18 | 99 | 98 | 11 × 17.5 × 11 | M6 | 8.08 × 10 ⁻⁷ | 3.7 | 5.7 | 3820 |
| | 76 | 121 | 146 | 18 | 128 | 98 | 11 × 17.5 × 11 | M6 | 8.08 × 10 ⁻⁷ | 3.7 | 5.7 | 3820 |
| | 74 | 108 | 139 | 18 | 121 | 90 | 9 × 14 × 8.5 | M6 | 8.08 × 10 ⁻⁷ | 3.81 | 5.82 | 3850 |
| | 75 | 120 | 111 | 18 | 93 | 98 | 11 × 17.5 × 11 | M6 | 1.29 × 10 ⁻⁶ | 3.45 | 7.1 | 3440 |
| | 75 | 120 | 123 | 18 | 105 | 98 | 11 × 17.5 × 11 | M6 | 1.29 × 10 ⁻⁶ | 3.82 | 7.1 | 3440 |
| | 75 | 120 | 171 | 18 | 153 | 98 | 11 × 17.5 × 11 | M6 | 1.29 × 10 ⁻⁶ | 4.84 | 7.1 | 3440 |
| | 78 | 123 | 123 | 18 | 105 | 100 | 11 × 17.5 × 11 | M6 | 1.29 × 10 ⁻⁶ | 4.69 | 7.99 | 3420 |
| | 78 | 123 | 140 | 18 | 122 | 100 | 11 × 17.5 × 11 | M6 | 1.29 × 10 ⁻⁶ | 4.34 | 7.99 | 3420 |
| | 78 | 123 | 195 | 18 | 177 | 100 | 11 × 17.5 × 11 | M6 | 1.29 × 10 ⁻⁶ | 5.67 | 7.99 | 3420 |
| | 78 | 123 | 140 | 18 | 122 | 100 | 11 × 17.5 × 11 | M6 | 1.29 × 10 ⁻⁶ | 4.31 | 7.99 | 3420 |
| | 75 | 114 | 122 | 18 | 104 | 93 | 11 × 17.5 × 11 | M6 | 1.29 × 10 ⁻⁶ | 3.4 | 7.54 | 3440 |
| | 82 | 124 | 103 | 18 | 85 | 102 | 11 × 17.5 × 11 | M6 | 1.97 × 10 ⁻⁶ | 3.61 | 8.87 | 3110 |
| | 82 | 124 | 123 | 18 | 105 | 102 | 11 × 17.5 × 11 | M6 | 1.97 × 10 ⁻⁶ | 3.97 | 8.87 | 3110 |
| | 82 | 124 | 163 | 18 | 145 | 102 | 11 × 17.5 × 11 | M6 | 1.97 × 10 ⁻⁶ | 5.33 | 8.87 | 3110 |
| | 84 | 126 | 119 | 18 | 101 | 104 | 11 × 17.5 × 11 | M6 | 1.97 × 10 ⁻⁶ | 4.36 | 8.83 | 3090 |
| | 84 | 126 | 143 | 18 | 125 | 104 | 11 × 17.5 × 11 | M6 | 1.97 × 10 ⁻⁶ | 4.92 | 8.83 | 3090 |
| | 84 | 126 | 191 | 18 | 173 | 104 | 11 × 17.5 × 11 | M6 | 1.97 × 10 ⁻⁶ | 6.47 | 8.83 | 3090 |
| | 84 | 126 | 144 | 18 | 126 | 104 | 11 × 17.5 × 11 | M6 | 1.97 × 10 ⁻⁶ | 4.9 | 9.09 | 3090 |
| | 82 | 126 | 162 | 18 | 144 | 104 | 11 × 17.5 × 11 | M6 | 1.97 × 10 ⁻⁶ | 5.17 | 9.37 | 3110 |

Note) The overall length of the nut will increase when equipping the QZ lubricating device. See **A15-318** for further details.