

DIK With Preload

DN value	70,000
----------	--------

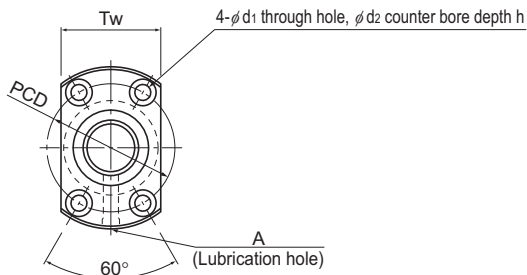

Model No.	Screw shaft outer diameter d	Lead Ph	Ball center-to-center diameter dp	Thread minor diameter dc	No. of loaded circuits Rows × turns	Basic load rating		Rigidity K N/ μ m
						Ca kN	C _{0a} kN	
DIK 1404-4	14	4	14.5	11.8	2 × 1	3	5.1	190
DIK 1404-6	14	4	14.5	11.8	3 × 1	4.2	7.7	280
DIK 1605-6	16	5	16.75	13.2	3 × 1	7.4	13	310
DIK 2004-6	20	4	20.5	17.8	3 × 1	5.2	11.6	380
DIK 2004-8	20	4	20.5	17.8	4 × 1	6.6	15.5	510
DIK 2005-6	20	5	20.75	17.2	3 × 1	8.5	17.3	310
DIK 2006-6	20	6	21	16.4	3 × 1	11.4	21.5	410
DIK 2008-4	20	8	21	16.4	2 × 1	8.1	14.4	280
DIK 2504-6	25	4	25.5	22.8	3 × 1	5.7	15	470
DIK 2504-8	25	4	25.5	22.8	4 × 1	7.4	19.9	620
DIK 2505-6	25	5	25.75	22.2	3 × 1	9.7	22.6	490
DIK 2506-4	25	6	26	21.4	2 × 1	9.1	18	330
DIK 2506-6	25	6	26	21.4	3 × 1	12.8	27	490
DIK 2508-4	25	8	26	21.4	2 × 1	9.2	18.8	340
DIK 2508-6	25	8	26	21.4	3 × 1	13.1	28.1	500
DIK 2510-4	25	10	26	21.6	2 × 1	9	18	330

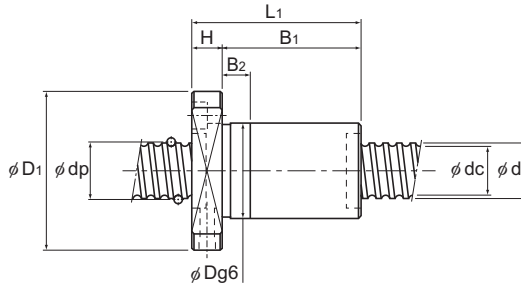

Unit: mm

	Nut dimensions										Screw shaft inertial moment/mm ³	Nut mass	Shaft mass	Permissible rotational speed
	Outer diameter	Flange diameter	Overall length							Lubrication hole				
	D	D ₁	L ₁	H	B ₁	B ₂	PCD	d ₁ ×d ₂ ×h	Tw	A				
	26	45	48	10	38	10	35	4.5×8×4.5	29	M6	2.96×10 ⁻⁸	0.2	1	4,820
	26	45	60	10	50	10	35	4.5×8×4.5	29	M6	2.96×10 ⁻⁸	0.23	1	4,820
	30	49	60	10	50	10	39	4.5×8×4.5	31	M6	5.05×10 ⁻⁸	0.3	1.25	4,170
	32	56	62	11	51	15	44	5.5×9.5×5.5	35	M6	1.23×10 ⁻⁷	0.34	2.18	3,410
	32	56	70	11	59	15	44	5.5×9.5×5.5	35	M6	1.23×10 ⁻⁷	0.37	2.18	3,410
	34	58	61	11	50	10	46	5.5×9.5×5.5	36	M6	1.23×10 ⁻⁷	0.38	2.06	3,370
	35	58	76	11	65	15	46	5.5×9.5×5.5	36	M6	1.23×10 ⁻⁷	0.48	1.93	3,330
	35	58	69	11	58	15	46	5.5×9.5×5.5	36	M6	1.23×10 ⁻⁷	0.45	2.06	3,330
	38	63	63	11	52	15	51	5.5×9.5×5.5	39	M6	3.01×10 ⁻⁷	0.43	3.5	2,740
	38	63	71	11	60	15	51	5.5×9.5×5.5	39	M6	3.01×10 ⁻⁷	0.47	3.5	2,740
	40	63	61	11	50	10	51	5.5×9.5×5.5	41	M6	3.01×10 ⁻⁷	0.47	3.35	2,710
	40	63	60	11	49	10	51	5.5×9.5×5.5	41	M6	3.01×10 ⁻⁷	0.46	3.19	2,690
	40	63	72	11	61	15	51	5.5×9.5×5.5	41	M6	3.01×10 ⁻⁷	0.54	3.19	2,690
	40	63	71	12	59	15	51	5.5×9.5×5.5	41	M6	3.01×10 ⁻⁷	0.54	3.35	2,690
	40	63	94	12	82	25	51	5.5×9.5×5.5	41	M6	3.01×10 ⁻⁷	0.68	3.35	2,690
	40	63	85	15	70	20	51	5.5×9.5×5.5	41	M6	3.01×10 ⁻⁷	0.65	3.45	2,690

Note: The overall length of the nut will increase when equipping the QZ Lubricator. See **A15-364** for further details.