

BNK0810-3 Shaft Diameter: 8; Lead: 10

DN value

70,000

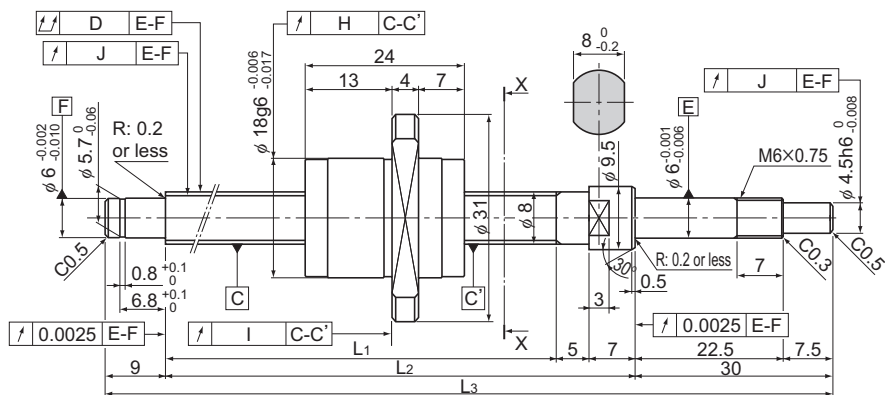

Model No.	Stroke	Screw shaft length		
		L_1	L_2	L_3
BNK 0810-3GT+205LC5Y	100	154	166	205
BNK 0810-3G2+205LC7Y				
BNK 0810-3GT+255LC5Y	150	204	216	255
BNK 0810-3G2+255LC7Y				
BNK 0810-3GT+305LC5Y	200	254	266	305
BNK 0810-3G2+305LC7Y				
BNK 0810-3GT+355LC5Y	250	304	316	355
BNK 0810-3G2+355LC7Y				
BNK 0810-3GT+405LC5Y	300	354	366	405
BNK 0810-3G2+405LC7Y				

Positioning Ball Screw

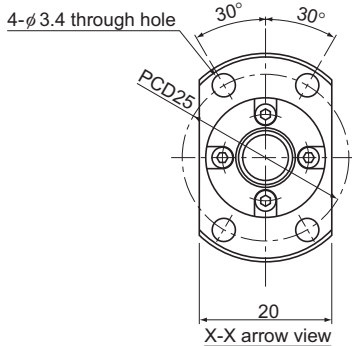

Ball screw specifications		
Lead (mm)	10	
BCD (mm)	8.4	
Thread minor diameter (mm)	6.7	
Threading direction, No. of threaded grooves	Rightward, 2	
No. of circuits	1.5 turns × 2 rows	
Clearance symbol	GT	G2
Axial clearance (mm)	0.005 or less	0.02 or less
Basic dynamic load rating C_a (kN)	2.16	2.16
Basic static load rating C_{0a} (kN)	3.82	3.82
Preload torque (N·m)	—	—
Spacer ball	None	None
Rigidity value (N/μm)	100	
Circulation method	End cap	

Unit: mm

	Runout of the screw shaft axis D	Runout of the nut circumference H	Flange mounting surface runout I	Runout of the thread groove surface J	Lead angle accuracy		Nut mass kg	Shaft mass kg/m	Permissible rotational speed min ⁻¹
					Representative travel distance error	Fluctuation			
	0.05	0.012	0.01	0.01	±0.02	0.018	0.049	0.3	3,500
	0.065	0.02	0.014	0.014	Travel distance: ±0.05/300		0.049	0.3	3,500
	0.05	0.012	0.01	0.01	±0.023	0.018	0.049	0.3	3,500
	0.065	0.02	0.014	0.014	Travel distance: ±0.05/300		0.049	0.3	3,500
	0.05	0.012	0.01	0.01	±0.023	0.018	0.049	0.3	3,500
	0.065	0.02	0.014	0.014	Travel distance: ±0.05/300		0.049	0.3	3,500
	0.06	0.012	0.01	0.01	±0.023	0.018	0.049	0.3	3,500
	0.075	0.02	0.014	0.014	Travel distance: ±0.05/300		0.049	0.3	3,500
	0.07	0.012	0.01	0.01	±0.025	0.018	0.049	0.3	3,500
	0.09	0.02	0.014	0.014	Travel distance: ±0.05/300		0.049	0.3	3,500