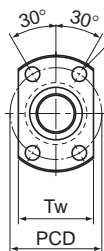

# MDK (Unfinished Shaft Ends) No Preload

DN value	70000
----------	-------

4- $\phi$  d<sub>1</sub> through hole

Model No.	Ball screw specifications							Nut			
	Screw shaft outer diameter	Lead	Ball center-to-center diameter	Thread minor diameter	No. of loaded circuits	Basic load rating		Outer diameter	Flange diameter	Overall length	Nut
						Ca	C <sub>0a</sub>				
d	Ph	dp	dc	Rows X turns	kN	kN	D	D <sub>1</sub>	L <sub>1</sub>	H	
MDK 0401-3	4	1	4.15	3.4	3×1	0.29	0.42	9	19	13	3
MDK 0601-3	6	1	6.2	5.3	3×1	0.54	0.94	11	23	14.5	3.5
MDK 0801-3	8	1	8.2	7.3	3×1	0.64	1.4	13	26	15	4
MDK 0802-3	8	2	8.3	7	3×1	1.4	2.3	15	28	22	5
MDK 1002-3	10	2	10.3	9	3×1	1.5	2.9	17	34	22	5

## Model number coding

**MDK0401-3 GT +95L C5 A**

Model No.

Overall screw shaft length (in mm)

Unfinished shaft ends code

Symbol for clearance in the axial direction (\*1) Accuracy symbol (\*2)

(\*1) See **A15-19**. (\*2) See **A15-12**.

## Positioning Ball Screw

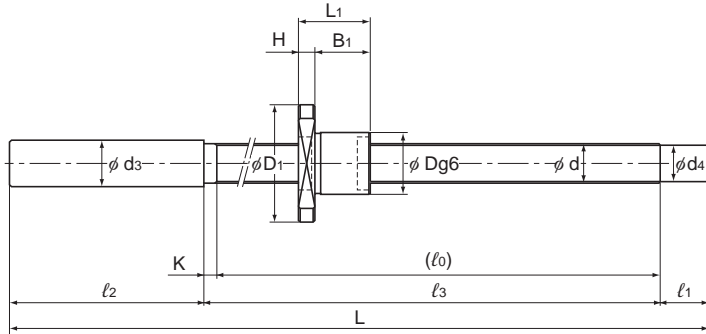

Unit: mm

Dimensions					Screw shaft dimensions									Nut mass kg	Shaft mass kg/m
B <sub>1</sub>	PCD	d <sub>i</sub>	Tw	Unfinished Shaft End Code	Overall length		l <sub>1</sub>	l <sub>2</sub>	l <sub>3</sub>	d <sub>3</sub>	d <sub>4</sub>	K			
					L	l <sub>0</sub>									
10	14	2.9	13	A	95	47	10	35	50	6.2	3.2	3	0.01	0.07	
					115	67			70						
					145	97			100						
11	17	3.4	15	A	120	67	10	40	70	8.2	5.3	3	0.02	0.14	
					150	97			100						
					180	127			130						
11	20	3.4	17	A	130	67	15	45	70	10.2	7.3	3	0.02	0.29	
					160	97			100						
					190	127			130						
					240	177			180						
17	22	3.4	19	A	140	76	15	45	80	10.2	7	4	0.04	0.27	
					170	106			110						
					200	136			140						
					250	186			190						
17	26	4.5	21	A	160	86	15	55	90	12.2	9	4	0.05	0.47	
					210	136			140						
					260	186			190						
					310	236			240						

Note) Models MDK 0401, 0601, and 0801 are not provided with a labyrinth seal.