

# BNF No Preload

DN value	7000
----------	------

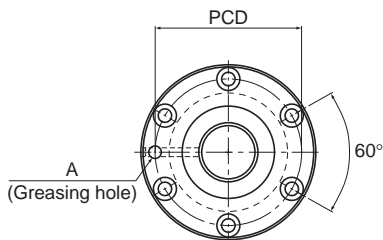

Model No.	Screw shaft outer diameter d	Lead Ph	Ball center-to-center diameter dp	Thread minor diameter dc	No. of loaded circuits Rows X turns	Basic load rating		Rigidity K N/μm
						Ca kN	C <sub>0a</sub> kN	
BNF 7010-2.5	70	10	71.75	64.5	1×2.5	36.8	123.5	590
BNF 7010-5	70	10	71.75	64.5	2×2.5	66.9	247	1140
BNF 7010-7.5	70	10	71.75	64.5	3×2.5	94.9	371.4	1680
BNF 7012-2.5	70	12	72	64.2	1×2.5	43.5	139.2	600
BNF 7012-5	70	12	72	64.2	2×2.5	78.9	278.3	1160
BNF 7012-7.5	70	12	72	64.2	3×2.5	111.7	417.5	1710
BNF 7020-5	70	20	72.7	62.9	2×2.5	153.9	514.5	1550
BNF 8010-2.5	80	10	81.75	75.2	1×2.5	38.9	141.1	650
BNF 8010-5	80	10	81.75	75.2	2×2.5	70.6	283.2	1270
BNF 8010-7.5	80	10	81.75	75.2	3×2.5	100	424.3	1860
BNF 8020A-2.5	80	20	82.7	72.9	1×2.5	90.1	294	890
BNF 8020A-5	80	20	82.7	72.9	2×2.5	163.7	589	1720
BNF 8020A-7.5	80	20	82.7	72.9	3×2.5	231.6	883.2	2520
BNF 10020A-2.5	100	20	102.7	92.9	1×2.5	99	368.5	2110
BNF 10020A-5	100	20	102.7	92.9	2×2.5	179.3	737	4080
BNF 10020A-7.5	100	20	102.7	92.9	3×2.5	253.8	1105.4	6010

Note) The model numbers in dimmed type indicate semi-standard types.  
If desiring them, contact THK.

## Positioning Ball Screw

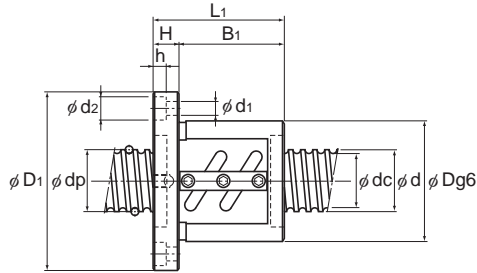

Unit: mm

	Nut dimensions							Greasing hole A	Screw shaft inertial moment/mm kg·m <sup>2</sup> /mm	Nut mass kg	Shaft mass kg/m
	Outer diameter D	Flange diameter D <sub>1</sub>	Overall length L <sub>1</sub>	H	B <sub>1</sub>	PCD	d <sub>1</sub> ×d <sub>2</sub> ×h				
	125	167	81	18	63	145	11×17.5×11	Rc1/8 (PT1/8)	1.85×10 <sup>-5</sup>	5.8	27.4
	125	167	111	18	93	145	11×17.5×11		1.85×10 <sup>-5</sup>	7.49	27.4
	125	167	141	18	123	145	11×17.5×11		1.85×10 <sup>-5</sup>	9.19	27.4
	128	170	93	18	75	148	11×17.5×11		1.85×10 <sup>-5</sup>	6.89	27.24
	128	170	129	18	111	148	11×17.5×11		1.85×10 <sup>-5</sup>	9.08	27.24
	128	170	165	18	147	148	11×17.5×11		1.85×10 <sup>-5</sup>	11.26	27.24
	130	186	185	28	157	158	18×26×17.5		1.85×10 <sup>-5</sup>	14.5	27
	130	176	77	22	55	152	14×20×13		3.16×10 <sup>-5</sup>	5.9	36.26
	130	176	107	22	85	152	14×20×13		3.16×10 <sup>-5</sup>	7.53	36.26
	130	176	137	22	115	152	14×20×13		3.16×10 <sup>-5</sup>	9.15	36.26
	143	204	127	28	99	172	18×26×17.5		3.16×10 <sup>-5</sup>	12.68	35.81
	143	204	187	28	159	172	18×26×17.5		3.16×10 <sup>-5</sup>	17.12	35.81
	143	204	247	28	219	172	18×26×17.5		3.16×10 <sup>-5</sup>	21.56	35.81
	170	243	131	32	99	205	22×32×21.5		7.71×10 <sup>-5</sup>	18.28	57.13
	170	243	191	32	159	205	22×32×21.5		7.71×10 <sup>-5</sup>	24.2	57.13
	170	243	251	32	219	205	22×32×21.5		7.71×10 <sup>-5</sup>	30.12	57.13

Note)The overall length of the nut will increase when equipping the QZ lubricating device. See **A15-318** for further details.