

DK No Preload

DN value	70000
----------	-------

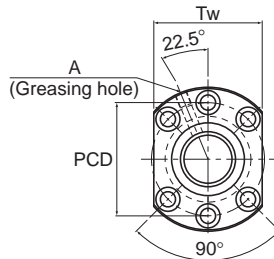

Model No.	Screw shaft outer diameter d	Lead Ph	Ball center-to-center diameter dp	Thread minor diameter dc	No. of loaded circuits Rows X turns	Basic load rating		Rigidity K N/μm
						Ca kN	Coa kN	
DK 5010-3	50	10	51.75	44.4	3×1	33.9	90.7	470
DK 5010-4	50	10	51.75	44.4	4×1	43.4	120.5	610
DK 5010-6	50	10	51.75	44.4	6×1	62.7	186.8	930
DK 5012-3	50	12	52.25	43.3	3×1	45.8	113	490
DK 5012-4	50	12	52.25	43.3	4×1	58.6	150.6	640
DK 5016-3	50	16	52.25	43.3	3×1	45.7	113.3	490
DK 5016-4	50	16	52.25	43.3	4×1	58.5	151	640
DK 5020-3	50	20	52.25	43.6	3×1	44.2	108.8	470
DK 6310-4	63	10	64.75	57.7	4×1	49.5	160.7	780
DK 6310-6	63	10	64.75	57.7	6×1	70.3	242.1	1140
DK 6312-3	63	12	65.25	56.3	3×1	51.9	147.4	600
DK 6312-4	63	12	65.25	56.3	4×1	66.4	196.6	785
DK 6320-3	63	20	65.7	55.9	3×1	83.5	229.3	1470

Positioning Ball Screw

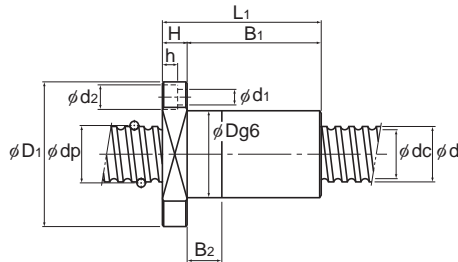

Unit: mm

	Nut dimensions										Screw shaft inertial moment/mm ³	Nut mass	Shaft mass
	Outer diameter	Flange diameter	Overall length	H	B ₁	B ₂	PCD	d ₁ × d ₂ × h	Tw	Greasing hole			
	D	D ₁	L ₁	H	B ₁	B ₂	PCD	d ₁ × d ₂ × h	Tw	A	kg·m ² /mm	kg	kg/m
	72	123	83	18	65	15	101	11 × 17.5 × 11	92	Rc1/8 (PT1/8)	4.82 × 10 ⁻⁶	2.14	13.38
	72	123	93	18	75	20	101	11 × 17.5 × 11	92		4.82 × 10 ⁻⁶	2.3	13.38
	72	123	114	18	96	30	101	11 × 17.5 × 11	92		4.82 × 10 ⁻⁶	2.65	13.38
	75	129	97	22	75	20	105	14 × 20 × 13	98		4.82 × 10 ⁻⁶	2.91	12.74
	75	129	110	22	88	25	105	14 × 20 × 13	98		4.82 × 10 ⁻⁶	3.16	12.74
	75	129	111	22	89	25	105	14 × 20 × 13	98		4.82 × 10 ⁻⁶	3.18	13.41
	75	129	129	22	107	30	105	14 × 20 × 13	98		4.82 × 10 ⁻⁶	3.52	13.41
	75	129	136	28	108	30	105	14 × 20 × 13	98		4.82 × 10 ⁻⁶	3.94	13.8
	85	146	97	22	75	20	122	14 × 20 × 13	110		1.21 × 10 ⁻⁵	3.28	21.93
	85	146	118	22	96	30	122	14 × 20 × 13	110		1.21 × 10 ⁻⁵	3.7	21.93
	90	146	98	22	76	20	122	14 × 20 × 13	110		1.21 × 10 ⁻⁵	3.71	21.14
	90	146	111	22	89	25	122	14 × 20 × 13	110		1.21 × 10 ⁻⁵	4.04	21.14
	95	159	136	28	108	30	129	18 × 26 × 17.5	121		1.21 × 10 ⁻⁵	6.17	21.57

Note) The overall length of the nut will increase when equipping the QZ lubricating device. See **A15-318** for further details.