

BNFN-V Small/Medium With Preload

| | | |
|----------|--------|--------|
| DN value | Small | 100000 |
| | Medium | 130000 |

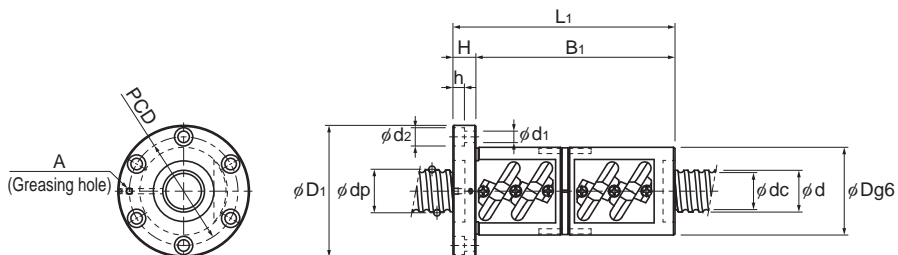

<Small> BNFN1605V/2805V/2806V/3205V

| Model No. | Screw shaft outer diameter d | Lead Ph | Ball center-to-center diameter dp | Thread minor diameter dc | No. of loaded circuits Rows X turns | Basic load rating | | Rigidity K N/μm |
|----------------|---------------------------------|------------|--------------------------------------|-----------------------------|--|-------------------|-----------------|-----------------------|
| | | | | | | Ca | C _{0a} | |
| | | | | | | kN | kN | |
| BNFN 1605V-5 | 16 | 5 | 16.75 | 13.2 | 2 × 2.5 | 13.5 | 27.9 | 640 |
| BNFN 2805V-7.5 | 28 | 5 | 28.75 | 25.2 | 3 × 2.5 | 24.8 | 73.8 | 1470 |
| BNFN 2806V-7.5 | 28 | 6 | 28.75 | 25.2 | 3 × 2.5 | 24.8 | 73.8 | 1470 |
| BNFN 3205V-7.5 | 32 | 5 | 32.75 | 29.2 | 3 × 2.5 | 26.2 | 84.4 | 1640 |
| BNFN 2810V-2.5 | 28 | 10 | 29.75 | 22.4 | 1 × 2.5 | 24.3 | 49 | 560 |
| BNFN 3610V-7.5 | 36 | 10 | 37.75 | 30.5 | 3 × 2.5 | 71 | 189.8 | 1990 |
| BNFN 3616V-5 | 36 | 16 | 38 | 30.1 | 2 × 2.5 | 58.3 | 142.9 | 1380 |
| BNFN 4016V-5 | 40 | 16 | 42 | 34.1 | 2 × 2.5 | 61.5 | 158.8 | 1500 |
| BNFN 4510V-7.5 | 45 | 10 | 46.75 | 39.5 | 3 × 2.5 | 78.8 | 237.8 | 2370 |
| BNFN 5010V-7.5 | 50 | 10 | 51.75 | 44.4 | 3 × 2.5 | 82.5 | 264.4 | 2580 |

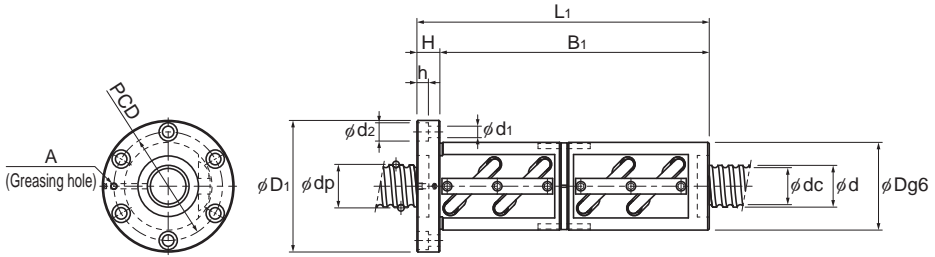

<Medium> BNFN2810V/3610V/3616V/4016V/4510V/5010V

Unit: mm

| | Nut dimensions | | | | | | | | Screw shaft inertial moment/mm kg·m ² /mm | Nut mass kg | Shaft mass kg/m |
|--|-------------------|--------------------|-------------------|----|----------------|-----|-------------------------------------|------------------|---|-------------------|-----------------------|
| | Outer diameter | Flange diameter | Overall length | H | B ₁ | PCD | d ₁ × d ₂ × h | Greasing hole | | | |
| | D | D ₁ | L ₁ | | | | | A | | | |
| | 40 | 60 | 106 | 10 | 96 | 50 | 4.5 × 8 × 4.5 | M6 | 5.05 × 10 ⁻⁸ | 0.88 | 1.37 |
| | 55 | 85 | 134 | 12 | 122 | 69 | 6.6 × 11 × 6.5 | M6 | 4.74 × 10 ⁻⁷ | 1.88 | 4.45 |
| | 55 | 85 | 158 | 12 | 149 | 69 | 6.6 × 11 × 6.5 | M6 | 4.74 × 10 ⁻⁷ | 2.16 | 4.52 |
| | 58 | 85 | 136 | 12 | 124 | 71 | 6.6 × 11 × 6.5 | M6 | 8.08 × 10 ⁻⁷ | 1.93 | 5.89 |
| | 65 | 106 | 146 | 18 | 128 | 85 | 11 × 17.5 × 11 | M6 | 4.74 × 10 ⁻⁷ | 3.41 | 4.15 |
| | 75 | 120 | 261 | 18 | 243 | 98 | 11 × 17.5 × 11 | M6 | 1.29 × 10 ⁻⁷ | 6.93 | 7.1 |
| | 78 | 123 | 268 | 18 | 250 | 100 | 11 × 17.5 × 11 | M6 | 1.29 × 10 ⁻⁷ | 7.8 | 7.99 |
| | 84 | 126 | 280 | 22 | 258 | 104 | 11 × 17.5 × 11 | M6 | 1.97 × 10 ⁻⁶ | 9.27 | 9.09 |
| | 88 | 132 | 261 | 18 | 243 | 110 | 11 × 17.5 × 11 | R1/8 (PT1/8) | 3.16 × 10 ⁻⁶ | 8.92 | 11.36 |
| | 93 | 135 | 253 | 18 | 235 | 113 | 11 × 17.5 × 11 | R1/8 (PT1/8) | 4.82 × 10 ⁻⁶ | 9.19 | 14.16 |

Note) The overall length of the nut will increase when equipping the QZ lubricating device. See [A15-356](#) for further details.
For model number coding, see [A15-238](#).