

# DK No Preload

DN value	70000
----------	-------

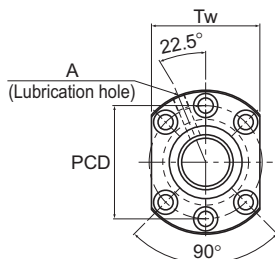

Model No.	Screw shaft outer diameter d	Lead Ph	Ball center-to-center diameter dp	Thread minor diameter dc	No. of loaded circuits Rows X turns	Basic load rating		Rigidity K N/μm
						Ca kN	C <sub>0a</sub> kN	
DK 5010-3	50	10	51.75	44.4	3 × 1	33.9	90.7	470
DK 5010-4	50	10	51.75	44.4	4 × 1	43.4	120.5	610
DK 5010-6	50	10	51.75	44.4	6 × 1	62.7	186.8	930
DK 5012-3	50	12	52.25	43.3	3 × 1	45.8	113	490
DK 5012-4	50	12	52.25	43.3	4 × 1	58.6	150.6	640
DK 5016-3	50	16	52.25	43.3	3 × 1	45.7	113.3	490
DK 5016-4	50	16	52.25	43.3	4 × 1	58.5	151	640
DK 5020-3	50	20	52.25	43.6	3 × 1	44.2	108.8	470
DK 6310-4	63	10	64.75	57.7	4 × 1	49.5	160.7	780
DK 6310-6	63	10	64.75	57.7	6 × 1	70.3	242.1	1140
DK 6312-3	63	12	65.25	56.3	3 × 1	51.9	147.4	600
DK 6312-4	63	12	65.25	56.3	4 × 1	66.4	196.6	785
DK 6320-3	63	20	65.7	55.9	3 × 1	83.5	229.3	1470

## Positioning Ball Screw

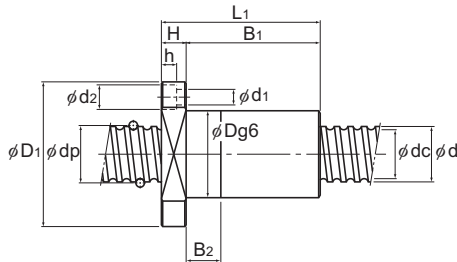

Unit: mm

	Nut dimensions										Screw shaft inertial moment/mm <sup>3</sup>	Nut mass	Shaft mass	Permissible rotational speed
	Outer diameter	Flange diameter	Overall length	H	B <sub>1</sub>	B <sub>2</sub>	PCD	d <sub>1</sub> ×d <sub>2</sub> ×h	Tw	Lubrication hole				
	D	D <sub>1</sub>	L <sub>1</sub>						A					
	72	123	83	18	65	15	101	11×17.5×11	92	Rc1/8 (PT1/8)	4.82×10 <sup>-6</sup>	2.14	13.38	1350
	72	123	93	18	75	20	101	11×17.5×11	92		4.82×10 <sup>-6</sup>	2.3	13.38	1350
	72	123	114	18	96	30	101	11×17.5×11	92		4.82×10 <sup>-6</sup>	2.65	13.38	1350
	75	129	97	22	75	20	105	14×20×13	98		4.82×10 <sup>-6</sup>	2.91	12.74	1330
	75	129	110	22	88	25	105	14×20×13	98		4.82×10 <sup>-6</sup>	3.16	12.74	1330
	75	129	111	22	89	25	105	14×20×13	98		4.82×10 <sup>-6</sup>	3.18	13.41	1330
	75	129	129	22	107	30	105	14×20×13	98		4.82×10 <sup>-6</sup>	3.52	13.41	1330
	75	129	136	28	108	30	105	14×20×13	98		4.82×10 <sup>-6</sup>	3.94	13.8	1330
	85	146	97	22	75	20	122	14×20×13	110		1.21×10 <sup>-5</sup>	3.28	21.93	1080
	85	146	118	22	96	30	122	14×20×13	110		1.21×10 <sup>-5</sup>	3.7	21.93	1080
	90	146	98	22	76	20	122	14×20×13	110		1.21×10 <sup>-5</sup>	3.71	21.14	1070
	90	146	111	22	89	25	122	14×20×13	110		1.21×10 <sup>-5</sup>	4.04	21.14	1070
	95	159	136	28	108	30	129	18×26×17.5	121		1.21×10 <sup>-5</sup>	6.17	21.57	1060

Note) The overall length of the nut will increase when equipping the QZ lubricating device. See **A15-344** for further details.