

WTF No Preload

DN value	70000
----------	-------

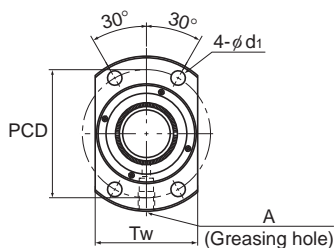

Model No.	Screw shaft outer diameter d	Lead Ph	Ball center-to-center diameter dp	Thread minor diameter dc	No. of loaded circuits Rows X turns	Basic load rating		Rigidity K	Outer diameter D	Flange diameter D ₁	Overall length	
						Ca	C _{0a}				L ₁	H
						kN	kN	N/μm	D	D ₁	L ₁	H
WTF 1520-3	15	20	15.75	12.5	2X1.5	5.5	14.2	140	32	53	45	10
WTF 1520-6	15	20	15.75	12.5	4X1.5	10.1	28.5	280	32	53	45	10
WTF 1530-2	15	30	15.75	12.5	4X0.6	4.3	9.3	120	32	53	33	10
WTF 1530-3	15	30	15.75	12.5	2X1.6	5.6	12.4	160	32	53	63	10
WTF 2040-2	20	40	20.75	17.5	4X0.65	5.4	13.6	160	37	57	41.5	10
WTF 2040-3	20	40	20.75	17.5	2X1.65	6.6	17.2	200	37	57	81.5	10
WTF 2550-2	25	50	26	21.9	4X0.65	8.5	21.2	200	45	69	52	12
WTF 2550-3	25	50	26	21.9	2X1.65	10.4	26.9	260	45	69	102	12
WTF 3060-2	30	60	31.25	26.4	4X0.65	11.8	30.6	240	55	89	62.5	15
WTF 3060-3	30	60	31.25	26.4	2X1.65	14.5	38.9	310	55	89	122.5	15
WTF 4080-2	40	80	41.75	35.2	4X0.65	19.8	54.5	320	73	114	79	17
WTF 4080-3	40	80	41.75	35.2	2X1.65	24.3	69.2	400	73	114	159	17
WTF 50100-2	50	100	52.2	44.1	4X0.65	29.6	85.2	390	90	135	98	20
WTF 50100-3	50	100	52.2	44.1	2X1.65	36.3	108.1	500	90	135	198	20

Model number coding

WTF3060-3 ZZ +1500L C7 T H1K

Model No.	Contamination protection accessory symbol (*)	Overall screw shaft length (in mm)	Symbol for rolled shaft	Accuracy symbol (*)	Recommended shaft ends shape code
-----------	---	------------------------------------	-------------------------	---------------------	-----------------------------------

(*) See **A15-308**. (*) See **A15-12**.

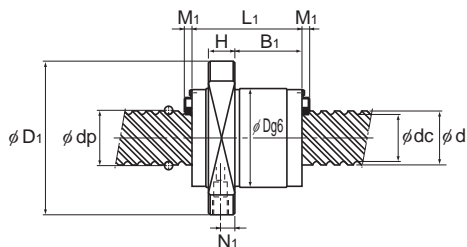

Unit: mm

Nut dimensions							Seal	Axial clearance	Standard shaft length	Screw shaft inertial moment kg·m ² /mm	Nut mass kg	Shaft mass kg/m
B ₁	PCD	d ₁	Tw	Greasing hole		M ₁						
				N ₁	A							
28	43	5.5	33	5	M6	3.5	0.1	500, 1000	3.90×10^{-8}	0.2	1.17	
28	43	5.5	33	5	M6	3.5	0.1	500, 1000	3.90×10^{-8}	0.2	1.17	
17	43	5.5	33	5	M6	3.5	0.1	500, 1000, 1500	3.90×10^{-8}	0.22	1.19	
47	43	5.5	33	5	M6	3.5	0.1	500, 1000, 1500	3.90×10^{-8}	0.4	1.19	
25.5	47	5.5	38	5.5	M6	3.5	0.1	500, 1000, 1500, 2000	1.23×10^{-7}	0.25	2.12	
65.5	47	5.5	38	5.5	M6	3.5	0.1	500, 1000, 1500, 2000	1.23×10^{-7}	0.5	2.12	
31.5	57	6.6	46	7	M6	3.5	0.1	1000, 1500, 2000, 3000	3.01×10^{-7}	0.45	3.34	
81.5	57	6.6	46	7	M6	3.5	0.1	1000, 1500, 2000, 3000	3.01×10^{-7}	0.85	3.34	
37.5	71	9	56	9	M6	3.8	0.14	1000, 2000, 3000, 4000	6.24×10^{-7}	0.8	4.84	
97.5	71	9	56	9	M6	3.8	0.14	1000, 2000, 3000, 4000	6.24×10^{-7}	1.7	4.84	
50.5	93	11	74	9	M6	5.4	0.17	1000, 1500, 2000, 3000	1.97×10^{-6}	2.1	8.66	
130.5	93	11	74	9	M6	5.4	0.17	1000, 1500, 2000, 3000	1.97×10^{-6}	3.67	8.66	
64	112	14	92	10	M6	5.4	0.2	1500, 3000	4.82×10^{-6}	3.5	13.86	
164	112	14	92	10	M6	5.4	0.2	1500, 3000	4.82×10^{-6}	6.4	13.86	

Note) The overall length of the nut will increase when equipping the QZ lubricating device. See **A15-318** for further details.