

JPF With Preload

| | |
|----------|-------|
| DN value | 50000 |
|----------|-------|

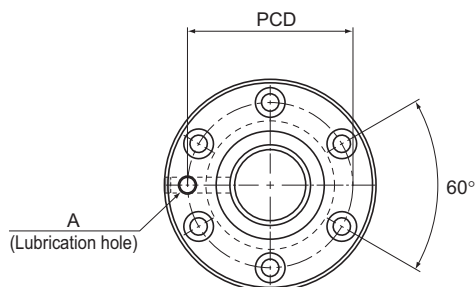

| Model No. | Screw shaft outer diameter d | Lead Ph | Ball center-to-center diameter dp | Thread minor diameter dc | No. of loaded circuits Rows X turns | Basic load rating | | Outer diameter D | Flange diameter D ₁ | Outer diameter D ₂ |
|------------|---------------------------------|------------|--------------------------------------|-----------------------------|--|----------------------|-----------------------|---------------------|-----------------------------------|----------------------------------|
| | | | | | | C _a kN | C _{0a} kN | | | |
| JPF 1404-4 | 14 | 4 | 14.4 | 11.5 | 2×1 | 2.8 | 5.1 | 26 | 46 | 25.5 |
| JPF 1405-4 | 14 | 5 | 14.5 | 11.2 | 2×1 | 3.9 | 8.6 | 26 | 46 | 25.5 |
| JPF 1605-4 | 16 | 5 | 16.75 | 13.5 | 2×1 | 3.7 | 8.2 | 30 | 49 | 29.5 |
| JPF 2005-6 | 20 | 5 | 20.5 | 17.2 | 3×1 | 6 | 16 | 34 | 57 | 33.5 |
| JPF 2505-6 | 25 | 5 | 25.5 | 22.2 | 3×1 | 6.9 | 20.8 | 40 | 66 | 39.5 |
| JPF 2510-4 | 25 | 10 | 26.8 | 20.2 | 2×1 | 11.4 | 24.5 | 47 | 72 | 46.5 |
| JPF 2805-6 | 28 | 5 | 28.75 | 25.2 | 3×1 | 7.3 | 23.9 | 43 | 69 | 42.5 |
| JPF 2806-6 | 28 | 6 | 28.5 | 25.2 | 3×1 | 7.3 | 23.9 | 43 | 69 | 42.5 |
| JPF 3210-6 | 32 | 10 | 33.75 | 27.2 | 3×1 | 19.3 | 49.9 | 54 | 88 | 53.5 |
| JPF 3610-6 | 36 | 10 | 37 | 30.5 | 3×1 | 20.6 | 56.2 | 58 | 98 | 57.5 |
| JPF 4010-6 | 40 | 10 | 41.75 | 35.2 | 3×1 | 22.2 | 65.3 | 62 | 104 | 61.5 |

Model number coding

JPF1404-4 RR G0 +500L C7 T

Model No. Seal symbol (*1) Overall screw shaft length (in mm) Symbol for rolled shaft

Symbol for clearance in the axial direction Accuracy symbol (*2)

(*1) See [A15-334](#). (*2) See [A15-12](#).

Transport Ball Screw

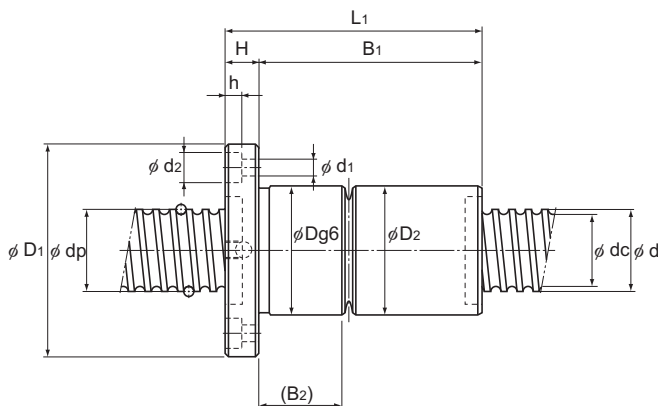

Unit: mm

| Nut dimensions | | | | | | | | Screw shaft inertial moment | Nut mass | Shaft mass | Permissible rotational speed |
|-------------------|----|----------------|----------------|-----|-------------------------------------|---------------------|-------------------------|--------------------------------|-------------|-------------------|------------------------------------|
| Overall length | H | B ₁ | B ₂ | PCD | d ₁ × d ₂ × h | Lubrication hole | | | | | |
| L ₁ | | | | | | A | kg·m ² /mm | kg | kg/m | min ⁻¹ | |
| 52 | 10 | 42 | 16.5 | 36 | 4.5 × 8 × 4.5 | M6 | 2.96 × 10 ⁻⁸ | 0.22 | 1 | 3470 | |
| 60 | 10 | 50 | 20 | 36 | 4.5 × 8 × 4.5 | M6 | 2.96 × 10 ⁻⁸ | 0.24 | 0.99 | 3440 | |
| 60 | 10 | 50 | 19.5 | 39 | 4.5 × 8 × 4.5 | M6 | 5.05 × 10 ⁻⁸ | 0.3 | 1.34 | 2980 | |
| 80 | 11 | 69 | 26.5 | 45 | 5.5 × 9.5 × 5.5 | M6 | 1.23 × 10 ⁻⁷ | 0.46 | 2.15 | 2430 | |
| 80 | 11 | 69 | 26 | 51 | 5.5 × 9.5 × 5.5 | M6 | 3.01 × 10 ⁻⁷ | 0.6 | 3.45 | 1960 | |
| 112 | 12 | 100 | 42 | 58 | 6.6 × 11 × 6.5 | M6 | 3.01 × 10 ⁻⁷ | 1.2 | 3.26 | 1860 | |
| 80 | 12 | 68 | 25 | 55 | 6.6 × 11 × 6.5 | M6 | 4.74 × 10 ⁻⁷ | 0.66 | 4.27 | 1730 | |
| 90 | 12 | 78 | 35 | 55 | 6.6 × 11 × 6.5 | M6 | 4.74 × 10 ⁻⁷ | 0.72 | 4.44 | 1750 | |
| 135 | 15 | 120 | 53.5 | 70 | 9 × 14 × 8.5 | M6 | 8.08 × 10 ⁻⁷ | 1.84 | 5.49 | 1480 | |
| 138 | 18 | 120 | 53.5 | 77 | 11 × 17.5 × 11 | M6 | 1.29 × 10 ⁻⁶ | 2.22 | 6.91 | 1350 | |
| 138 | 18 | 120 | 53.5 | 82 | 11 × 17.5 × 11 | Rc1/8 (PT1/8) | 1.97 × 10 ⁻⁶ | 2.42 | 8.81 | 1190 | |

Note) The ball screw nut and the screw shaft of model JPF are not sold separately.

The basic load rating corresponds to the recommended loading direction.

If a load is applied in the opposite direction, the value must be 0.1 × C_a or less during use.